

ALL METAL ... ALL THE TIME™

Industrial Metalworking Tooling & Solutions Since 1965



APR-JUN 2024



Depth & Angle Gages

save 25%

FEATURES:

- Heads made of hardened steel.
- Protractor graduations include 30°, 45°, and 60° angles.
- Center of head features recess cut-out for easy reading and more accurate measurement of depth.
- Gage includes 6" rule.
- Rule measures 7/32" wide and .041" thick with deeply etched, quick-reading markings.
- 6" non-graduated 3/32" steel rod included for measuring holes too narrow for use with the rule.

Part No. 1-804-509 **\$27⁹⁵**
Reg. Net Price \$37.26

OVERSTOCK SALE!
Quantities Limited.



Odor Control Tablets

One tablet per 25 gallons of coolant every week. Designed for small sumps, 200 gallons or less. 15 tablets per tube.

save 20%

FEATURES:

- No formaldehyde or harmful chemicals.
- Safer and more economical than biocides.
- Eliminates sump odors caused by hydrogen sulfide bacterial emissions.

Do Away with Coolant Stench!

Part No. 1-122-020 **\$34⁰⁷**
Reg. Net Price \$42.59



nova™ 18" Nova Voyager DVR Drill Press

1 HP, 115V, 1 PH

FEATURES:

- Digital Variable Reluctance (DVR) Direct Drive Technology with Adaptive Control™ Software which works for you to produce optimum results in wood, metal, plastic and glass.
- Constant torque under load, depth and vibration sensors and emergency stop.
- Slow start pilot hole, tapping assist with chip breaking cycle and self start functions.
- Electronic braking and forward/reverse.

COMPLETE WITH:

5/8" Drill chuck & key, firmware USB cable, knock-out wedge, adjustment wrench, and hex keys.

Model 58006

Part No. 6-125-076 **\$1,999⁰⁰**

SPECIFICATIONS:

Chuck Size 5/8"
Drilling Capacity 5/8"
Swing 18"
Spindle Taper 2 MT
Speeds (Var.) ... 50-3,000 RPM



NEW!

Milwaukee M18 FUEL™ 8" Metal Cutting Circular Saw

M18 FUEL™ 8" Cordless Circular Saw generates 15A corded power, faster cuts than 15A corded metal circular saws, and delivers up to 120' of cutting corrugated decking per charge.

FEATURES:

- Onboard chip collection.
- Overload indicator light turns yellow when user is pushing too hard, coaching the user to optimal cutting speed.
- Dual action trigger: eliminating accidental trigger actuation.
- Electric blade brake stops all blades in under one second.
- Tool-free adjustable shoe adjusts the shoe depth for optimal cutting capacity.
- Blade cut capacity: 2-9/16".
- Includes: (1) 42T Circular Saw Blade.

SPECIFICATIONS:

Depth of Cut 2-9/16"
No Load Speed 4,000 RPM
Tool Length 15.5"



Part No. 1-828-2982-20 **\$429⁰⁰**

[Click here for complete details.](#)

SUPERIOR 20 Pc. SHUR-KUT® Quick Change Disc Kit

CONTENTS:

- (5 Each) 2" discs A/O 36, 60, 80 & 120 grit.
- (1) Medium density holder with 1/4" shank.

Type "R"
Part No. 1-613-37500
Reg. Net Price \$34.07 **\$27²⁶**



Contains 20 of the most popular Shur-Kut® quick-change discs.



CALCULATED INDUSTRIES® Machinist Calc® Pro 2 Advanced Machining Math + Materials

FEATURES:

- Portable, rugged, and cost-effective handheld calculator.
- For face, end or slot milling plus turning, drilling, and boring.
- Includes materials and tool settings combined with DOC and WOC to solve all your speed and feed calculations.
- It gives you step-saving drill and thread chart look-ups, right triangle solutions, bolt-circle patterns, a larger 2-line LCD display, and much more.

INCLUDES:

- Quick Reference Guide and Easy-to-Follow User's Guide.
- Armadillo gear protective hard case.
- Long-life battery (CR2025).

Model 4088 **\$99⁹⁵**
Part No. 1-961-004



Great for machinists, setters, tool & die makers, supervisors, and shop owners.



WEB: **KBCTools.com**

PHONE: M-F 8am - 8pm, EST **1-800-521-1740**

FAX: **1-800-322-4292**

FAX ORDERS 24/7

- Cutting Tools 2-6
- Carbide Tooling 7
- Fluids 1, 25, 28
- Workholding Tools 8-9
- Abrasives 1, 10-11, 28
- Measuring & Inspection 1, 12-15, 28
- Toolroom Accessories 1, 24
- Hand Tools 26, 28
- Shop Supplies 22-23
- Power / Air Tools 1, 27
- Machinery 1, 16-21

Industrial Metalworking Tooling & Solutions Since 1965

3 Pc. TiN Coated Step Drill Set



save 25%

FEATURES:

- Easily sharpened.
- Tip does not slide, absolutely no need for a center punch.
- Designed to deburr as you go.
- Creates perfectly round holes in metal, plastic, wood, and other thin materials.

RANGES OF BITS:

1/8-1/2", 3/16-1/2", 1/4-3/4".

Part No. **5-331-3682** **\$23⁸⁵**
Reg. Net Price \$31.80

6" Silver & Deming Drills

HIGH SPEED STEEL

118° POINT

1/2" SHANK



FEATURES:

- Expands the size range capacity of a 1/2" portable drill chuck.
- Common flute and overall length for minimal adjustment during tool changes.
- Precision ground for a high degree of concentricity between shank and body diameter.
- Ideal for drilling in low and medium tensile strength materials.

Size	Part No. 1-060-	Reg. Net Price	NOW!
9/16"	-036	\$8.72	\$7.41
5/8"	-040	9.55	8.12
11/16"	-044	10.65	9.05
3/4"	-048	11.65	9.90
7/8"	-056	14.38	12.22
15/16"	-060	16.33	13.88
1"	-100	17.74	15.08
1-1/16"	-104	21.54	18.31
1-1/8"	-108	26.10	22.19
1-3/16"	-112	25.52	21.69
1-1/4"	-116	28.43	24.17
1-5/16"	-120	34.90	29.67
1-3/8"	-124	37.20	31.62
1-7/16"	-128	41.40	35.19
1-1/2"	-132	41.75	35.49



Solid Carbide Hi-Roc Drill Sets

Each set includes a selection of more frequently used, fractional size drills and comes packed neatly in a plastic case.

save 20%

No. of Drills	Sizes	Part No. 5-100-	Reg. Net Price	SALE!
5	1/8" to 3/8" by 16ths	-20181	\$232.56	\$186.05
7	1/16" to 1/4" by 32nds	-20367	204.04	163.23
10	3/64" to 3/16" by 64ths	-20526	237.05	189.64

CLE-LINE 25 Pc. Metric Jobbers Drill Set

HIGH SPEED STEEL

STRAIGHT SHANK

118° POINT

RIGHT HAND

save 20%

FEATURES:

- For general purpose drilling and maintenance applications.
- Helix Regular: 21° to 34°.
- 1 to 13mm by 0.5mm

Part No. **1-091AX-4025** **\$110¹⁴**
Reg. Net Price \$137.68

29 Pc. Cobalt Jobbers Drill Set



HIGH SPEED STEEL

135° SPLIT POINT

RIGHT HAND

save 20%

Designed to perform in a wide variety of normal conditions. Jobbers length also perform in a broad range of materials in both machine and portable drilling.

1/16" to 1/2" by 64ths w/ Index
Part No. **1-011-0290** **\$99⁹⁶**
Reg. Net Price \$124.95



29 Pc. SHOCKWAVE Impact Duty™ RED HELIX™ Titanium Drill Bit Set

Ideal for metal, wood, & plastics.



SET INCLUDES:
Sizes (1 Ea.) -
1/16 to 31/64"

Part No.
1-828-48894672
\$114⁹⁷

FEATURES:

- RED HELIX™ Technology combines QUAD EDGE™ tip, VARIABLE HELIX™ flute, and thicker tapered web.
- QUAD EDGE™ Tip™ stays sharper longer.
- VARIABLE HELIX™ flute designed for rapid chip removal.
- Thicker tapered web design increases bit strength.
- Titanium coated for 5x Life vs. black oxide drill bits.
- 1/4" hex shank for use with impact drivers and drill drivers.
- Laser etched size for easy identification.

100% SATISFACTION GUARANTEED:

If you are not 100% satisfied for any reason just return the unused item(s) in its original packaging within 30 days, with your receipt for a replacement, exchange, full credit or refund.



FREE SHIPPING:

Orders over \$349.00 (50 lbs. weight limit per order) SHIPPED FREE - via our standard shipping method. Some restrictions may apply.

99% of All Orders Ship the Same Day... Or you can Pick Up at your Local Branch.* Your Choice.



* Excludes Machinery & Non-Stock Items.

DAMAGED, LOST, OR SHORT SHIPMENTS:

It doesn't happen often, but if it does, call your local courier office immediately, and advise KBC so that we can reship and place a claim. Please keep damaged goods and containers until the claim is closed.

TRUCK SHIPMENTS:

KBC is not responsible for merchandise damaged or lost by motor freight carriers. If the shipment is damaged or short one or more packages, please have it noted by the truck driver on receipt and freight bill. If you accept a short or damaged shipment from the truck driver without proper notation by the driver, you do so at your own risk.

PRICING:

KBC Tools & Machinery traditionally holds prices for the duration of its sales flyers. As industrial market conditions continue to change across North America (tariffs, raw material, and price increases), KBC reserves the right to change prices based upon inventory conditions and supplier price increases without notice. BUY NOW! KBC Tools & Machinery strives to be your choice for all your tooling needs.

MINIMUM ORDER:

Only \$25.00, to cover processing costs.

OOPS!:

Errors do occur, so mistakes are subject to correction. Sorry for any inconvenience.

GSA Contract #BPA-GS-06F-4KBC7

KEO High Performance Solid Carbide NC Spotting Drills



142° POINT ANGLE

Spotting drills are designed with a narrow chisel edge for quick starting and constant web to allow for resharpening without the need for web thinning.



Size	Flute Length	OAL	Part No. 1-090A-	Reg. Net Price	SALE!
1/8"	5/8"	1-1/2"	-34184	\$20.94	\$17.80
3/16"	13/16"	2"	-34189	27.52	23.39
1/4"	13/16"	2-1/2"	-34144	35.11	29.84
5/16"	7/8"	2-1/2"	-34314	42.36	36.01
3/8"	7/8"	2-1/2"	-34384	48.48	41.21
1/2"	1-1/8"	3"	-34124	75.81	64.44

5 Pc. Solid Carbide Burr Set

1/4" Head Diameter,
1/4" Shank Diameter.



SET INCLUDES:
SA-1, SC-1,
SD-1, SG-1, SM-1.



Part No.
1-338-001
Reg. Net Price \$47.95 **\$40.76**

Supplied in a fitted plastic case.



Miniature Carbide Bur Set

1-1/2" OAL

Double Cut

Part No. 5-100-71033 **\$61.05**
Reg. Net Price \$71.82



SA-43 SC-42 SD-42 SG-41 SM-45 SL-42
1/8" Head Diameter, 1/8" Shank Diameter.



4 Pc. ZER0 Flute M35 Cobalt Countersinks & Deburring Tool Set

82° ANGLE
CNC PRECISION
CAM GROUND

STRAIGHT SHANK
CHATTERLESS
CUTTING ACTION

SIZES INCLUDED:
5/16", 3/8", 1/2", 5/8"

Part No. 1-159A-53518 **\$77.02**
Reg. Net Price \$90.61



FEATURES:

- Chamfer diameters ranging from 7/64" to 1-1/32".
- M35 cobalt; 6% tungsten, 5% moly, 5% cobalt - for long life in all types of materials.
- Through-hole design that is easy to resharpen using a small grinding wheel in the cross-hole.
- Free cutting action. Minimal power needed. Use by hand or machine feed.
- Works on all materials. Excels on aluminum, plastics, and other nonmetals.
- Micro-smooth CNC precision ground for clean smooth cutting without smearing.
- Simple all-purpose versatility that provides flawless countersinking and deburring.

20 Pc. TiN Coated 2 & 4 Flute Single End Mill Set

CENTER CUTTING HIGH SPEED STEEL

save 25%

SET INCLUDES
(1 Ea. 2 & 4 FLUTE):

- 3/16", 1/4", 5/16", 3/8" (3/8" Shank)
- 7/16", 1/2" (1/2" Shank)
- 9/16", 5/8" (5/8" Shank)
- 11/16", 3/4" (3/4" Shank)



Part No. 5-300T-100
Reg. Net Price \$139.99 **\$104.99**



4 Flute Center Cutting M-42 8% Cobalt Single End Mills

NEW!



O.D. TOLERANCE +.0000,-.0015



30° HELIX

For machining high strength alloys or 25% higher speeds on regular material.

Single end mills are designed for general milling operations. The spiral multi-flute design permits a faster and smoother cutting action. The end cutting edges are ground to permit center cutting.



4 Flute Premium Solid Carbide Center Cutting Miniature End Mills



Series 111

FEATURES:

- Micrograin 10% cobalt grade.
- Shank Diameter: 1/8"
- Overall Length: 1-1/2"

Size	Flute Length	Part No. 5-100-	Reg. Net Price	SALE!	Size	Flute Length	Part No. 5-100-	Reg. Net Price	SALE!
.005"	.015"	-51001	\$66.51	\$56.53	.055"	.165"	-51053	\$21.76	\$18.50
.010	.030	-51005	47.52	40.39	.060	.180	-51061	19.39	16.48
.015	.045	-51009	28.12	23.90	.065	.195	-51067	17.39	14.78
.020	.060	-51017	27.64	23.49	.070	.210	-51071	17.39	14.78
.025	.075	-51021	27.64	23.49	.075	.225	-51077	17.39	14.78
.030	.090	-51025	28.12	23.90	.080	.240	-51085	17.39	14.78
.035	.105	-51031	21.76	18.50	.085	.255	-51087	17.39	14.78
.040	.120	-51039	21.26	18.07	.090	.270	-51089	17.39	14.78
.045	.135	-51043	21.76	18.50	.095	.285	-51093	17.39	14.78
.050	.150	-51049	21.76	18.50	.100	.300	-51099	17.39	14.78



Designed for aggressive milling of most materials.

4 Flute Extra Long Length Single End Mills



NEW!



30° HELIX HIGH SPEED STEEL

O.D. TOLERANCE +.0000,-.0015

Extra long flute for the deepest cut. Single end mills are designed for general milling operations. The spiral multi-flute design permits a faster and smoother cutting action.

Mill Dia.	Shank Dia.	Length of Cut	OAL	Part No. 5-425A-	Reg. Net Price	SALE!
1/4"	3/8"	1-3/4"	3-1/2"	-44007	\$16.65	\$14.15
5/16	3/8	2	3-3/4"	-44012	17.35	14.75
3/8	3/8	2-1/2"	4-1/4"	-44017	17.78	15.11
1/2	1/2	3	5	-44022	22.86	19.43
5/8	5/8	4	6-1/8"	-44027	33.14	28.17
5/8	1/2	4	6	-44031	33.14	28.17
3/4	3/4	4	6-1/4"	-44037	38.77	32.95
3/4	1/2	4	6	-44041	38.77	32.95
7/8	7/8	5	7-1/4"	-44047	51.32	43.62
1	1	6	8-1/2"	-44052	67.68	57.53

Standard Length TiN Coated Solid Carbide Single End Mills



Designed for general milling operations. Spiral multi-flute design permits a faster and smoother cutting action.

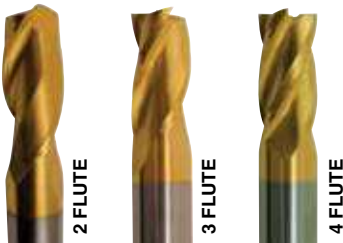

Flute Dia.	Shank Dia.	Flute Length	OAL	2 Flute			3 Flute			4 Flute		
				Part No. 1-325C-	Reg. Net Price	SALE!	Part No. 1-330C-	Reg. Net Price	SALE!	Part No. 1-326C-	Reg. Net Price	SALE!
1/16"	1/8"	3/16"	1-1/2"	-004	\$7.15	\$6.08	-004	\$7.15	\$6.08	-004	\$7.15	\$6.08
1/8	1/8	1/2	1-1/2"	-008	7.15	6.08	-008	7.15	6.08	-008	7.15	6.08
3/16	3/16	5/8	2	-012	10.69	9.09	-012	10.69	9.09	-012	10.69	9.09
1/4	1/4	3/4	2-1/2"	-016	13.50	11.48	-016	13.50	11.48	-016	13.50	11.48
5/16	5/16	7/8	2-1/2"	-020	16.42	13.96	-020	16.42	13.96	-020	16.42	13.96
3/8	3/8	7/8	2-1/2"	-024	21.00	17.85	-024	21.00	17.85	-024	21.00	17.85
7/16	7/16	1	2-1/2"	-028	32.40	27.54	-028	32.40	27.54	-028	32.40	27.54
1/2	1/2	1	3	-032	33.00	28.05	-032	33.00	28.05	-032	33.00	28.05

5 Pc. Single Flute Countersink Set



82° ANGLE

SET INCLUDES:

- 1/4", 3/8" 1/2" with 1/4" shank.
- 3/4", 1" with 1/2" shank.

Part No. 5-380-5895
Reg. Net Price \$54.90
\$46⁶⁷



FEATURES:

- Recommended for portable and machine work when operated at comparatively high speed.
- Countersink holes much smaller than multi-flute tools.

Starrett 13 Pc. Deep Cut Bi-Metal General Purpose Hole Saw Kit

Exceptionally strong, safe, and shatter resistant. Allows cutting through a depth of 2".

KIT INCLUDES:

- DCH Series Hole Saws - 3/4", 7/8", 1-1/8", 1-3/8", 1-1/2", 1-3/4", 2", 2-1/4", 2-1/2".
- A1E Extended Length Arbor.
- A2E Extended Length Quick Hitch Arbor.
- A014CE Extra-Length HSS Pilot Drill.
- A12 Arbor Adapter.



Starrett #KDC09051-N
Part No. 1-856-01218
Reg. Net Price \$211.70
\$190⁵³



Outside Chamfering Mills

HIGH SPEED STEEL

FEATURES:

- Chatterless design.
- Designed to chamfer a variety of diameters on tubing, pipe, and round stock.
- Use on drill presses, screw machines, lathes or other chucking machines.



Major Work Dia.	Actual Mouth Dia.	Recess Hole	Body Dia.	Body Length	Thread Size	60°			90°		
						Part No. 1-162-	Reg. Net Price	SALE!	Part No. 1-162-	Reg. Net Price	SALE!
1/4"	5/16"	3/64"	1/2"	1"	5/16"-24	-601	\$45.75	\$41.18	-901	\$42.90	\$38.61
1/2"	5/8"	1/8"	7/8"	1-1/4"	3/8"-24	-602	59.20	53.28	-902	55.85	50.27
3/4"	7/8"	1/4"	1-1/8"	1-3/4"	1/2"-20	-603	68.10	61.29	—	—	—
1"	1-1/8"	3/16"	1-1/2"	1-5/16"	1/2"-20	—	—	—	-903	65.95	59.36
1-1/2"	1-1/8"	1/4"	1-1/2"	2"	3/4"-16	-604	94.95	85.46	—	—	—
1-1/2"	1-1/8"	1/4"	1-3/8"	1-3/4"	3/4"-16	—	—	—	-904	91.80	82.62
1-1/2"	1-5/8"	5/8"	2-1/2"	1-7/8"	3/4"-16	—	—	—	-905	152.70	137.43

Solid Carbide Reamers



STRAIGHT SHANK

STRAIGHT FLUTE

4 Flute: Below 1/4" Dia.
6 Flute: On Larger Sizes

For general purpose reaming applications in ferrous metals and most non-ferrous materials. Precision ground with straight flutes for making smooth, accurate holes while retaining long tool life.



Size	Decimal Equiv.	Flute Length	OAL	Part No. 5-661-	Reg. Net Price	SALE!
1/16"	.0625"	3/8"	1-1/2"	-018	\$14.44	\$12.27
1/8"	.1250"	5/8"	2-1/4"	-044	19.62	16.68
3/16"	.1875"	7/8"	2-3/4"	-066	26.34	22.39
1/4"	.2500"	1"	3"	-087	35.13	29.86
5/16"	.3125"	1-1/8"	3-1/4"	-100	47.25	40.16
3/8"	.3750"	1-1/4"	3-1/2"	-111	56.67	48.17
7/16"	.4375"	1-3/8"	3-3/4"	-117	73.59	62.55
1/2"	.5000"	1-3/8"	4"	-121	91.92	78.13

Straight Shank Taper Car Reamers

With Collar



SPIRAL FLUTE
HIGH SPEED STEEL

Taper car reamers have the same features as bridge reamers except for shorter flute and overall length facilitating their use in tight quarters. Collared reamers prevent over penetration.



Reamer Diameter	Shank Diameter	Shank Length	Flute Length	OAL	Part No. 5-057X-	Reg. Net Price	SALE!
3/8"	3/8"	1-1/2"	2-3/4"	4-5/8"	-004	\$31.70	\$26.95
1/2"	1/2"	1-1/2"	4"	5-7/8"	-010	36.96	31.42
9/16"	1/2"	1-1/2"	4"	5-7/8"	-015	39.95	33.96
5/8"	1/2"	1-1/2"	4-1/2"	6-3/8"	-020	44.60	37.91
11/16"	1/2"	1-1/2"	4-1/2"	6-3/8"	-025	53.45	45.43
3/4"	1/2"	1-1/2"	5"	6-7/8"	-030	63.00	53.55
7/8"	1/2"	1-1/2"	5"	6-7/8"	-040	76.90	65.37
1"	1/2"	1-1/2"	5"	6-7/8"	-050	87.20	74.12

Carbide Tipped Toolbits Style AL & AR

GRADE C-5

STRAIGHT TURNING TOOLS

Style A tools are designed for turning, boring or facing to a square shoulder. Maximum regrinds are possible for light cutting where the maximum wear occurs at or near the front face of the tool.

Shank Dimensions			Left Hand			Right Hand		
Square	Length	Nose Radius	Part No. 1-2445-	Reg. Net Price	SALE!	Part No. 1-2445-	Reg. Net Price	SALE!
3/8"	2-1/2"	1/64"	-AL6	\$6.25	\$5.31	-AR6	\$6.25	\$5.31
1/2"	3-1/2"	1/32"	-AL8	8.40	7.14	-AR8	8.40	7.14



REICHEL Machinists Tap Wrenches

EASY TO USE:

- Place guide in chuck.
- Insert Wrench in guide.
- Tap into work guided.
- Measures thread depth.
- Lathe or drill press.

FEATURES:

- Heat-treated adjust nut.
- Heat-treated jaws.
- Sliding handle.
- Standard tap wrench.
- Heavy duty.

Tap Sizes	Part No. 1-397-	Reg. Net Price	SALE!
0 - 1/4"	-101	\$36.61	\$31.12
1/4 - 1/2"	-102	44.71	38.00
1/2 - 3/4"	-103	93.44	79.42
3/4 - 1"	-104	218.26	185.52



Style E

GRADE C-5 NEUTRAL 60°

AMERICAN STANDARD

Style E tool is designed to cut an American Standard 60° V thread.

Shank Size	Length	Part No. 1-2445-	Reg. Net Price	SALE!
3/8"	2-1/2"	-E6	\$6.08	\$5.17
1/2"	3-1/2"	-E8	8.05	6.84

Click here for complete details.



Style D

GRADE C-5 POINTED NOSE

80° INCLUDED ANGLE

Style D tools may be used for finish turning, chamfering or boring in either right or left hand directions.

Shank Size	Length	Nose Radius	Part No. 1-2445-	Reg. Net Price	SALE!
3/8"	2-1/2"	1/64"	-D6	\$6.08	\$5.17
1/2"	3-1/2"	1/32"	-D8	8.05	6.84

Click here for complete details.

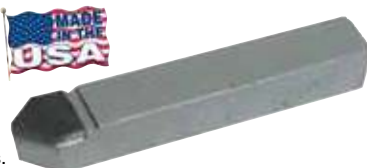

The duMONT Company, LLC



Individual Keyway Broaches

HIGH SPEED STEEL



INCH

Broach	Keyway Width	Broach Dimensions	Shims Req.	No. of Teeth	Length of Cut		Part No. 1-400-	Reg. Net Price	SALE!
					Min.	Max.			
A	1/8"	1/8 x 5	1	18	13/64	1-1/8"	-22203	\$73.95	\$65.07
B	1/8"	3/16 x 6-3/4"	1	16	19/64	1-11/16"	-22205	87.85	77.30
B	3/16"	3/16 x 6-3/4"	1	16	19/64	1-11/16"	-22207	87.85	77.30
C	1/4"	3/8 x 11-3/4"	1	22	25/64	2-1/2"	-22209	110.75	97.46
C	3/8"	3/8 x 11-3/4"	2	22	25/64	2-1/2"	-22211	110.75	97.46
D	3/8"	9/16 x 13-7/8"	2	17	1	6"	-22213	169.35	149.02
D	1/2"	9/16 x 13-7/8"	3	17	1	6"	-22215	169.35	149.02



VARDEX

External Threading Toolholders

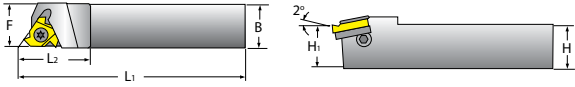

Model No.	H, H ₁ B	F	L ₁	L ₂	Part No. 1-289R-	Reg. Net Price	NOW!
AL 050-3	.50"	.63"	3.5"	.87"	-005	\$107.63	\$91.49
AL 0625-3	.63	.63	5.0	1.02	-006	107.63	91.49
AL 075-3	.75	.75	5.0	1.02	-010	107.63	91.49
AL 100-3	1.00	1.00	6.0	1.02	-015	113.03	96.08
AL 125-3	1.25	1.25	7.0	1.18	-020	125.59	106.75

INSERT SIZE: 3/8" I.C.

All toolholders are supplied with 1-1/2° helix-angle. Supplied with anvil.

VARDEX

Internal Threading Toolholders



RIGHT HAND

All toolholders are supplied with 1-1/2° helix-angle.

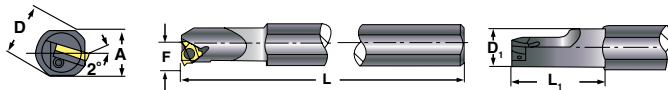

Model No.	Insert Size (I.C.)	Dimensions						Min. Minor Dia. of Thread	Part No. 1-289R-	Reg. Net Price	NOW!
		A	L	L ₁	D	D ₁	F				
NVR 0375-2	1/4"	.67"	7"	1.00"	.75"	.37"	.28"	.50"	-090	\$132.74	\$112.83
NVR 050-3	3/8	.67	7	1.43	.75	.50	.37	.67	-096	132.74	112.83
NVR 0625-3		.67	7	1.50	.75	.625	.46	.80	-100	112.78	95.86
AVR 075-3		.67	7	1.50	.75	.75	.51	.90	-105	146.93	124.89
AVR 100-3		1.12	10	2.50	1.25	1.00	.65	1.20	-110	162.34	137.99

Prefix N: No anvil used. Prefix A: Supplied with anvil.

MIO DEX™ 7 Pc. Indexable Toolholder & Boring Bar Sets

For use with 80° diamond positive clearance CCMT inserts.

Complete with 4-layer coated carbid inserts, Torx screws and Torx key.

Supplied with a fitted wooden case.

Tool Styles Included in Set (1 each)	Shank Size	CCMT Insert Series	Part No. 1-428-	Reg. Net Price	SALE!
SCLCR, SCLCL	3/8"	21.51	-407103	\$309.00	\$278.10
SCBCR, SCKCR, SCMCN, SCSCR, & SCLCR	1/2"		-407104	330.75	297.68
	5/8"		-407105	445.75	401.18

MICRO 100™ CCMT Carbide Insert 80° Diamond

MICRO 100 is a space age, micro grain carbide of excellent quality. It is in a class of its own, resulting from the exclusive treating process. Micro grain carbide has superior rupture strength for exceptional machining versatility. It is also highly shock resistant, it will not chip or break under normal machining conditions and is unexcelled in interrupted cutting. It prolongs tool life in machining all hard stainless steels, and also efficiently performing in exotic metals.

Insert Style	I.C.	Hole Dia.	Thickness	Corner Radius	Part No. 1-428-	Reg. Net Price	SALE!
CCMT 21.51	1/4"	.110"	3/32"	1/64"	-501100	\$11.15	\$10.04

MIO DEX™ SI-SCLC R Indexable Boring Bars

FEATURES:

- Negative 3° side & end cut edge angle.
- Uses 80° diamond positive clearance CCMT inserts.

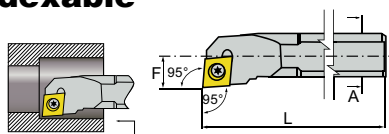

Boring Bar Style	Shank Size	Min. Bore	OAL L	Center Line F	Insert Series	Part No. 6-870-	Reg. Net Price	SALE!
SI-SCLCR 4-2	.315"	.354"	4"	.1875"	21.51	-042	\$64.60	\$54.91
SI-SCLCR 6-2	.375	.468	6"	.2500		-062	64.60	54.91
SI-SCLCR 8-2	.500	.560	7"	.2900		-082	64.60	54.91
SI-SCLCR 10-2	.625	.850	8"	.4050		-085	86.45	73.48
SI-SCLCR 8-3	.500	.625	7"	.3120	32.52	-083	65.55	55.72
SI-SCLCR 10-3	.625	.812	8"	.4060		-103	76.00	64.60
SI-SCLCR 12-3	.750	1.000	10"	.5000		-123	81.70	69.45
SI-SCLCR 16-3	1.000	1.120	12"	.6094		-163	103.55	88.02

KORLOY™

Style SP Carbide Inserts

GRADE NC-3030: Excellent coated grade for rough cuts in steel & steel alloys. Equivalent to P20-P40 & M20-M40 grade. Recommended Cutting Speed: 250-650 SFM.

Insert Style	W	l	r	Part No. 1-244X-	Reg. Net Price	SALE!
SP300	.122"	.445"	.008"	-SP3	\$13.43	\$11.42
SP400	.161	.445	.010	-SP4	13.84	11.76

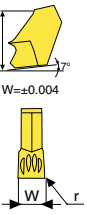

NIKCOLE MINI-SYSTEMS Grooving & Cut-Off Set

For Grooving & Cut-Off Under .078" Width



Supplied with a fitted case.

FEATURES:

- The only system that provides you with two cutting edges in one insert in extremely narrow widths.
- Positive locking insert screw & unique insert pocket design assures a repeatable cutting edge location.

SET INCLUDES:

- (1) Right Hand Toolholder 1/2" SQ x 4-1/2" L.
- (5) TIN Coated Standard Grooving Inserts:
 - .035" W x .100" T
 - .043" W x .235" T
 - .051" W x .235" T
 - .063" W x .235" T
 - .073" W x .235" T
- (1) Screw & Torx Key.

Part No. 1-293-015

Reg. Net Price **\$184.06**
\$156.45

MIO DEX™ Adjustable Cut-Off Blades

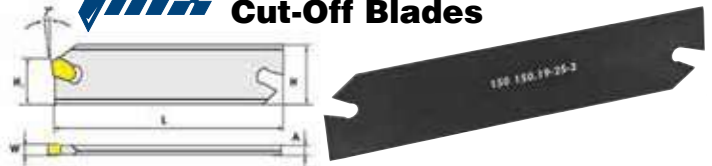

Insert Size	Blade Size (H)	H1	L	W	A	Max Dia.	Part No. 6-895-	Reg. Net Price	SALE!
GTN-2	1.02"	.83"	4.33"	.087"	.065"	1.97"	-262	\$96.90	\$82.37
				.122	.091	2.95	-263	95.95	81.56
				.161	.126	3.15	-264	92.15	78.33
				.201	.169	3.15	-265	95.00	80.75
GTN-3	1.26	.97	5.91	.122	.091	3.94	-323	108.30	92.06
				.166	.126	3.94	-324	102.60	87.21
				.201	.169	4.70	-325	110.20	93.67

MICRO 100™ APKT Carbide Insert

MICRO 100 is a space age, micro grain carbide of excellent quality. It is in a class of its own, resulting from the exclusive treating process. Micro grain carbide has superior rupture strength for exceptional machining versatility. It is also highly shock resistant, it will not chip or break under normal machining conditions and is unexcelled in interrupted cutting. It prolongs tool life in machining all hard stainless steels, and also efficiently performing in exotic metals.

Insert Style	I.C.	L	T	r	F	Part No. 1-428-	Reg. Net Price	SALE!
APKT 1003PDR	.264"	.413"	.137"	.020"	.047"	-502100	\$12.25	\$11.03

MIO DEX™ Indexable End Mills

Indexable End Mills

FEATURES:

- For use with positive parallelogram, 11° clearance, APKT 1003 inserts.
- Each holder includes high precision M2.5 x T-8 Torx Screw and Torx key.

Cutting Dia.	Cutter Length	No. of Flutes	OAL	Shank Dia.	Part No. 1-428-	Reg. Net Price	SALE!
3/8"	1-1/2"	1	3"	1/2"	-311216	\$116.60	\$104.94
1/2"	1-1/2"	1	3	1/2	-311616	130.25	117.23
5/8"	1-1/2"	2	3	1/2	-311816	143.95	129.56
3/4"	2"	3	4-3/8"	3/4	-312424	198.75	178.88
				3/4	-313224	212.40	191.16
1-1/4"	2"	5	4-3/8"	3/4	-314024	316.55	284.90

Magnetic Chuck Block Parallels

FEATURES:

- Precision ground on all surfaces.
- Sold in pairs only.

1" x 2" x 4"

Part No. 1-546-008

Reg. Net Price \$49.68

\$42²³ /Pair

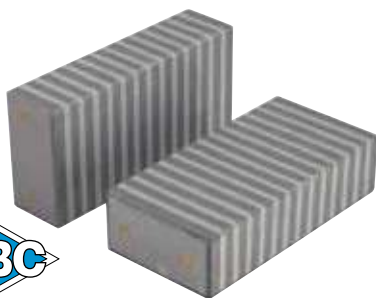

Mill Caddy

With the mill caddy from Edge Technology you can now hang your vise handle, dead blow hammer and air line from the front of the milling machine table.

The mill caddy allows for a less cluttered work area by placing your most frequently used tools out of the way.

[Click here for complete details.](#)



Part No. 1-811-06000 **\$21²⁴**
Reg. Net Price \$24.99

LFA® Heavy-Duty Key-Type Precision Chucks

Chuck Model	Jacobs Equiv.	Capacity Inches	Tapered Mount	Jacobs Key	Part No. 1-507-	Reg. Net Price	NOW!
81	1A	0 - 1/4	1JT	K1	-500	\$42.90	\$34.46
82	32	0 - 3/8	2JT	K2	-501	135.59	115.25
43	34	0 - 1/2	6JT	K3	-502	152.44	129.57
43	34	0 - 1/2	33JT	K3	-519	152.50	129.63
84	3A	1/32 - 5/8	3JT	K3	-503	234.95	199.71
85*	—	1/16 - 3/4	4JT	K4	-507	276.89	235.36
45	36	3/16 - 3/4	3JT	K3	-504	267.49	227.37
85B	—	3/16 - 1-1/32	4JT	K4	-505	463.15	393.68

Heavy-duty performance. Plain bearing models precision crafted. All parts are hardened for maximum tool life.

*Extra Heavy-Duty Model



Jacobs® Chuck Keys

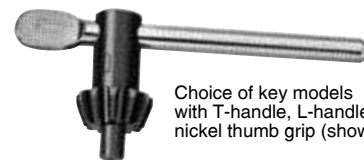

Choice of key models with T-handle, L-handle or nickel thumb grip (shown).

Model	Handle Style	Part No. 1-508-	Reg. Net Price	SALE!
K1	T-Handle	-3641	\$5.82	\$5.24
K2	Thumb	-3649	8.22	7.40
K3	Thumb	-3651	9.77	8.79
K4	Thumb	-3655	14.73	13.26

ROYAL® Chuck Stop Sets

The Royal Chuck Stop provides a simple, consistent method for locating short parts in a 3-jaw lathe chuck by allowing short parts to project past the chuck jaws, providing clearance for facing operations.

FEATURES:

- Captive, web-shaped design eliminates the danger of using spacers or parallels that could come loose and be thrown from a spinning chuck. Three strong magnets further secure the stop to the chuck face.
- Setup time is greatly reduced - no need to bore soft jaws.
- Slot width can be easily enlarged for wider chuck jaws.
- Anodized finish provides good wear-resistance.

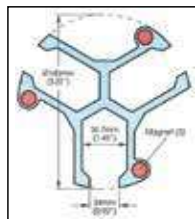

Description	Part No. 1-533-	Reg. Net Price	SALE!
3 Pc Set - Includes 15, 20 & 25mm	-25200	\$385.00	\$365.75
5 Pc Set - Includes 15, 20, 25, 30 & 35	-25210	669.00	635.55



Jacobs® Morse Taper Chuck Arbors



Taper Shank	Jacobs Taper	Part No. 1-508-	Reg. Net Price	SALE!
2MT	3JT	-7308	\$26.75	\$22.74
2MT	6JT	-7311	36.66	31.16
2MT	33JT	-7312	27.29	23.20
3MT	3JT	-7315	36.18	30.75
3MT	4JT	-7316	42.41	36.05
3MT	6JT	-7318	38.13	32.41
3MT	33JT	-7319	36.92	31.38
4MT	3JT	-7321	56.94	48.40
4MT	4JT	-7322	58.77	49.95
4MT	6JT	-7324	59.84	50.86
4MT	33JT	-7325	60.17	51.14

Mini Horizontal/Vertical Rotary Tables

FEATURES:

- Table clamping surface are precision ground and cylindrical center bore concentric.
- Supplied with a pair of mounting clamps.
- Dual position tables used for circular cutting, angle setting, boring and spot facing operations.
- Horizontal and vertical rotary tables come with 360° graduations.
- Features dual positive action locks with extra deep coolant channel.



Indexing plate not included.

Diameter	Center Hole	Worm Ratio	Weight (lbs.)	Part No. 1-397-	Reg. Net Price	NOW!
3"	1 MT	1:60	8.9	-5566	\$187.10	\$159.04
4"	2 MT	1:72	14.5	-5561	267.30	227.21

Riten® Econo Tri-Bearing Live Centers

FEATURES:

- Three rows of bearings.
- Points are through-hardened to 61-63 Rc.
- Accuracy guaranteed to ±0.00005 or better.
- Sealed bearings lubricated for life, protected against contaminants and coolant.
- Max. Speed: 2,500 RPM.
- Weight: 300 lbs.

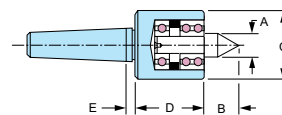

Morse Taper	A	B	C	D	E	Part No. 1-435-	Reg. Net Price	SALE!
2	9/16"	13/16"	1-5/8"	1-5/8"	1/4"	-44102	\$256.00	\$217.60
3	13/16	1	2	1-15/16	1/4	-44103	264.00	224.40
4	1	1-1/4	2-3/8	2-1/4	1/4	-44104	352.00	299.20

TECHNIKS® 43 Pc. CAT40 V-Flange Tooling Package

ER COLLET CHUCK FEATURES:

- Power coat nut holds up to 75% tighter than standard nuts to extend cutting tool life.
- Factory balanced to 25,000 RPM.
- Collet precision .0002" .

END MILL HOLDER FEATURES:

- Manufactured to H5 tolerance.
- Factory balanced to 10,000 RPM.
- Lab tested and lab certified.



Model No. TP-C40
Part No. 7-520-TPC40
Reg. Net Price \$2,103.00
\$1,682⁴⁰



SET INCLUDES:

Qty.	Description
4	CAT40, ER 32 x 2.76" Collet Chuck
2	CAT40, ER 16 x 2.76" Collet Chuck
1	10 pc. ER 16 - Inch Collet Set
1	18 pc. ER 32 - Inch Collet Set
1	CAT40, 1/4" x 3" End Mill Holder
1	CAT40, 3/8" x 3" End Mill Holder
1	CAT40, 1/2" x 3" End Mill Holder
1	CAT40, 5/8" x 3" End Mill Holder
1	CAT40, 3/4" x 3-1/2" End Mill Holder
1	CAT40, 1" x 4" End Mill Holder
1	CAT40, 1/2" x 4" Drill Chuck
1	ER 16 - Wrench
1	ER 32 - Wrench



Pro Vise Stop For 6" Vises

Single Side
Part No. 1-811-03000
Reg. Net Price \$59.99
\$50⁹⁹

NEW!



FEATURES:

- Locate long stock with the included stop rod collar.
- Double side allows two workpieces to be located for increased productivity.
- Low profile design stays below the top surface of vise jaws for cutter clearance.
- Non-marring 1/4"-20 nylon tip set screw used to secure stop rod mount without damage to lever arm.
- Versatile design allows the 1/4" hardened stop rod to be quickly and accurately positioned.
- Lever arm can be rotated out of the way for cutter clearance and accurately relocated for repeat setup.

Vise Clamp Workstop



FEATURES:

- Fits most 6" milling machine vises.
- Clamps quickly and easily to top of jaw.

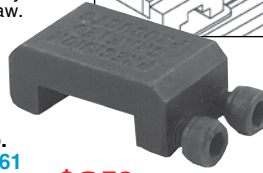
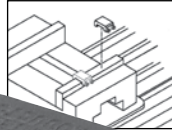

Part No. 1-541-161
Reg. Net Price \$10.07
\$8⁵⁶

LYNDEX R8 Round Collets

"Precision Grade"



Size (inch)	Part No. 1-5250-	Reg. Net Price	SALE!
1/8"	-008	\$35.00	\$31.50
3/16	-012	35.00	31.50
1/4	-016	35.00	31.50
5/16	-020	35.00	31.50
3/8	-024	35.00	31.50
1/2	-032	35.00	31.50
5/8	-040	35.00	31.50
3/4	-048	35.00	31.50
7/8	-056	44.00	39.60
1*	-100	44.00	39.60

* Light Duty.

TMX CAT 40 V-Flange Precision Ball Bearing Keyless Drill Chucks



FEATURES:

- Keyless operations.
- Draw Bar Threads: 5/8"-11
- Self-tightening (clockwise rotation only).
- Integral shank design is more compact than a combined drill chuck and arbor. It gives greater accuracy and rigidity.
- Made of alloy forged steel for long, durable service life.

PRODUCED ACCORDING TO AT3 SPECIFICATIONS.

Chuck Capacity	Chuck Dia.	Gage Length	Part No. 7-081-	Reg. Net Price	SALE!
1/32-1/2"	2"	4.13"	-750	\$284.05	\$241.44
1/8-5/8"	2-1/4"	5.12"	-751	304.95	259.21

13 Pc. R8 Round Collet Set



SIZES:
1/8" to 7/8" by 16ths

FEATURES:

- Made of high grade steel.
- Internal Thread: 7/16"-20.
- Hardened & precision ground.

Part No. 1-519-020
Reg. Net Price \$131.15

\$111⁴⁸

Magnetic Adjustable Link

For welding and holding steel plates in position.



Two heavy-duty Alnico magnetic blocks 2" long x 1" square, linked together with two nickel plated bars with wing nuts for easy angle adjustment.

Part No. 1-397-375
Reg. Net Price \$38.60

\$32⁸¹

The Premier R8 Collet Rack

The Original R8 Collet Saver!

Holds a complete set of 12 R8 collets.

FEATURES:

- Ideal accessory for Bridgeport Series I and other similar mills.
- Pick out sizes at a glance.
- Will not mar or damage collets.
- Easy to install - No holes to drill and tap.
- Attaches in minutes to machines or benches.
- Protects collet shanks from chips and coolant.
- Made of high strength materials for tried and proven durability.



Part No. 1-588-125
Reg. Net Price \$32.95

\$28⁰¹



TE-CO Single Station Machine Vises

Single station machine vises have a more robust main screw that can handle higher torque loads and transmit higher clamping pressure. The angled slide and locking jaw design prevents lifting of the moveable jaw.

REPEATABILITY 0.001"

FEATURES:

- Hardened vise bed and jaw plates.
- Outside rails of body are machined.
- Stationary jaw has machined keyway for alignment of the vise and includes alignment rail for quick setups.
- Footprint and distance from the keyway to stationary jaw meets industry standard.

SPECIFICATIONS:	4" Vise	6" Vise	8" Vise
Max. Jaw Opening	6"	9"	11"
Jaw Width	4"	5.94"	8"
Jaw Depth	1.38"	1.75"	2.2"
Vise Length	14.22"	17.206"	21.81"
Vise Width	6.3"	8.77"	11.5"
Weight	33 lbs.	81 lbs.	175 lbs.



NEW!

4" VISE FEATURES:

- The largest opening in its class of 6".
- Powder coated paint resists flaking and peeling.
- Sealed and lubricated needle roller thrust bearing for maximum life and minimum torque.
- Up to 7,000 lbs. of clamping force.
- Bed height matched to size 2-1/4" +/- 0.0005".

Part No. 1-903-PWS4600
Reg. Net Price \$656.00

\$590⁴⁰



Shop Vises

FEATURES:

- Built in pipe jaws handle various pipe sizes.
- Large anvil work surface.
- Replaceable serrated top jaws.
- Rubber pinch point safety guards.
- 360° swivel base with double lockdown for quick and easy positioning.



Jaw Width	Max. Opening	Jaw Depth	Weight (lbs.)	Part No. 1-550-	Reg. Net Price	SALE!
4"	4"	2-3/4"	22	-63300	\$234.60	\$199.41
5"	5"	3"	31	-63301	283.90	241.32
6"	6"	3-1/2"	42	-63302	411.40	349.69
8"	8"	4"	71	-63304	618.80	525.98



6" VISE FEATURES:

- The largest opening in its class of 9".
- Sealed bearing system reduces clamping pressure and increases bearing life.
- Up to 8,200 lbs. of clamping force.
- Bed height matched to size 2-7/8" +/- 0.0005".

Part No. 1-903-PWS6900
Reg. Net Price \$898.70

\$763⁹⁰



8" VISE FEATURES:

- The largest opening in its class of 11".
- Powder coated paint resists flaking and peeling.
- 80,000 PSI ductile iron body with increased nickel content for improved corrosion resistance.
- Sealed and lubricated needle roller thrust bearing for maximum life and minimum torque.
- The 4 bolt design on the stationary jaw reduces deflection by 25%.
- Up to 120,000 lbs. of clamping force.
- Bed height matched to size 3.31" +/- 0.0005".

Part No. 1-903-PWS8110
Reg. Net Price \$2,099.50

\$1,889⁵⁵



Grinding Wheel Dresser

Fulfill most general dressing needs where fast dressing is the primary requirement.



Dresser No.	For Use on Wheels		Complete Dresser			Cutters Only				
	Diameter	Face	Part No. 1-607-	Reg. Net Price	SALE!	Diameter	Hole	Part No. 1-607-	Reg. Net Price	SALE!
No. 0	Up to 10"	2"	-125	\$29.34	\$24.94	1-1/4"	1/4"	-140	\$3.42	\$3.08
No. 1	10 to 16"	2-3/4"	-130	\$36.45	\$30.98	1-1/2"	1/2"	-145	4.68	4.21

CGW AZ Surface Grinding Wheels

VITRIFIED BONDED - AZ: Premium Blue Aluminum Oxide. Fast and cool cutting characteristics suitable for grinding heat sensitive, alloy steels and mold steels (high speed steels under 58RC).

7" x 1/2" x 1-1/4"
Max. Speed: 3,760 RPM

Grit	Part No. 1-595-	Reg. Net Price/Ea.	SALE!
46-H	-34318	\$23.00	\$18.40
46-I	-34319	23.00	18.40
46-J	-34320	23.00	18.40
46-K	-34321	23.00	18.40
60-H	-34323	21.80	17.44
60-I	-34324	23.00	18.40
60-J	-34325	23.00	18.40
60-K	-34326	23.00	18.40
80-K	-34329	23.00	18.40
100-K	-34330	23.00	18.40



VIREX-CUT ABRASIVES SIGMA GREEN Grinding Wheels

For aluminum, stainless steel, mild steel, hard face, titanium, alloys.

SIGMA GREEN is an aggressive grinding wheel manufactured with a specialty grain and bond combination resulting in a better finish. This is achieved by constructing SIGMA GREEN with a layer of coarse grain and a second layer of finer grain.

FEATURES:

- 36 Grit, fast stock removal.
- High performance grain.
- Controlled, smooth, and quiet grinding.
- Superior finish.
- Cool cutting.
- Won't discolor or warp stainless.
- Reduces labor rates.
- Minimizes operator fatigue.



Size	Max. RPM	Arbor Hole	Part No. 1-603-	Reg. Net Price	SALE!
4-1/2"	13,300	7/8"	-045	\$7.60	\$6.08
	13,300	5/8-11	-050	10.21	8.17
5"	12,200	7/8"	-053	10.21	8.17
	12,200	5/8-11	-054	12.31	9.85
7"	8,500	7/8"	-055	13.50	10.80
	8,500	5/8-11	-060	15.64	12.51



NORTON SAINT-GOBAIN Combination Bench Stones

Combination Grit: Smooth cutting aluminum oxide abrasive, Norton's patent for a fine finish. Long lasting cutting edge. Ideal for clean deburring, generating keen edges and quality finishes.



India - Aluminum Oxide
Part No. 1-632-85560 \$32.33
Reg. Net Price \$38.03



Crystalon (Silicon Carbide): Fast cutting stone; ideal for general sharpening of cutting tools. Fast stock removal for quick edge loading with minimal loading.

Part No. 1-632-85450 \$35.06
Reg. Net Price \$41.25

6" X 2" X 1"
COARSE/FINE GRIT

SHAVIV Deburring Tools THE FINISHING TOUCH...



HIGH SPEED STEEL

Internal and external rotary deburring tool. Twist of the wrist motion for convenient deburring of holes and radii.

Model B10



Part No. 1-457-008
Reg. Net Price \$2.30
\$1.73

Excellent for materials with spiral chips such as aluminum, plastics, steels, etc. For longer life.

Model B10P



Part No. 1-457-008X
Reg. Net Price \$3.15
\$2.36

PVD Titanium Nitride coated B10 blade for high wear conditions.

Model B20



Part No. 1-457-010
Reg. Net Price \$2.30
\$1.73

Ideal for brass, cast iron, & other materials with powdery chip. Deburrs both clockwise & counter-clockwise directions.

Model B20P



Part No. 1-457-010T
Reg. Net Price \$3.27
\$2.45

PVD titanium coated B20 blade for high wear conditions.

SPECIAL BUY!

Model B25



A very thin blade specifically designed to deburr soft plastics.

Part No. 1-457-066
Reg. Net Price \$2.44 **.98¢**



CGW Quickie Cut ABRASIVES Reinforced Cut-Off Wheels

Zirconia and Aluminum Oxide mixture. General purpose wheel. Zirconia grain allows for faster cutting and longer life. Excellent on steel/stainless.



TYPE 1 TYPE 1 .045" - RIGID

Size	Grade	Max. RPM	Part No. 1-602-	ONLY!
4-1/2" x .045" x 7/8"	ZA-36-T-RIGID	13,300	-35514	\$2.08
5 x .045 x 7/8	ZA-36-T-RIGID	12,250	-35516	2.46
6 x .045 x 7/8	ZA-36-T-RIGID	10,200	-35517	2.66
7 x 1/16 x 7/8	ZA-36-T-RIGID	8,500	-35518	4.10

TYPE 27 TYPE 27

Size	Grade	Max. RPM	Part No. 1-602-	ONLY!
4-1/2" x .045" x 7/8"	ZA60-S-BF	13,300	-45002	\$2.43
5 x .045 x 7/8	ZA60-S-BF	12,250	-45005	2.97
6 x .045 x 7/8	ZA60-S-BF	10,200	-45007	3.33
7 x 1/16 x 7/8	ZA60-S-BF	8,500	-45008	4.86

Chamfering & Deburring Machine

OVERSTOCK SALE!
Quantities Limited.

FEATURES:

- Ideal for chamfering/deburring of small workpiece.
- Includes: (6) SPU-422 inserts in indexable milling cutter.
- Easy set-up.

SPECIFICATIONS:

Voltage 1 PH, 110V/60Hz
Speed 3500 RPM
Length of Guide Rails 20"
Chamfering Capacity 0 to 1/8"
Chamfering Angle 15° to 45°
Space Requirement 20" x 12"
Weight 67 lbs.



Part No. 1-548-100
Reg. Net Price \$918.00
\$688.50

3M Roloc™ 3" Disc Intro Pack

Introductory pack of 3" diameter Roloc™ surface conditioning discs, 3M™ Cubitron™ II coated abrasive discs, and Roloc™ disc pad for high performance jobs. This pack provides an easy way to evaluate the right product, size and grade for your application.

PACK INCLUDES:

- 3" 3M™ Cubitron™ II Roloc™ Durable Edge Discs 984F (3 Ea. - Grades 36+, 60+, 80+).
- 3" Scotch-Brite™ Roloc™ Surface Conditioning Discs (2 Ea. - Grades S SFN, A VFN, A MED, A CRS).
- 3" 3M™ Roloc™ Disc Pad TR (hard) 1/4" Thread Shaft.



OVERSTOCK SALE!
Quantities Limited.

Part No. **1-630-82900** **\$95⁴⁸**
Reg. Net Price \$136.40

12 Pc. 5-1/2" Needle File Set

#2 Medium Cut Economy



Part No. **4-130-999**
Reg. Net Price \$9.95
\$7⁹⁶

Supplied in a wallet.

SET INCLUDES (1 EA.):

- Flat.
- Joint.
- Knife.
- Round.
- Slitting.
- Square.
- Barrette.
- Marking.
- Crossing.
- Equaling.
- Half-Round.
- Three Square.

Crescent NICHOLSON® 4 Pc. Handy Man's Home File Pack

For home and professional use. Plastic pouch lists suggested uses for each file.



- ### FEATURES:
- (1) 8" Mill Bastard File
 - (1) 8" Four-In-Hand File
 - (1) 6" Slim Taper File
 - (1) 6" Round Bastard File

Part No. **1-552-22017** **\$30³⁰**
Reg. Net Price \$40.40



SUPERIOR SHUR-BRITE® Surface Conditioning Quick Change Discs

Finish Duty (F.D.) products enable the operator to prepare the work piece with a required surface finish.

FEATURES:

- Added flexibility.
- Maintain a repeatable measured finish.
- Provides a consistent cut rate.

APPLICATIONS:

- Blending
- Deburring
- Scale Removal
- Rust Removal
- Stock Removal
- Weld Splatter Removal

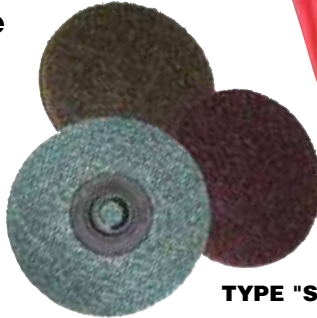

TYPE "S"

**STRONGER - QUICKER
RELIABLE - LONGEVITY**

Size	Grit	Color	Part No. 1-613-	Reg. Net Price/Ea.	NOW!
2"	50/box	Coarse	-10544	\$1.49	\$1.34
		Medium	-10545	1.43	1.29
		Very Fine	-10546	1.43	1.29

SUPERIOR 2" SHUR-KUT® Quick Change Discs

Equal to SocAtt®, PowerLock II®, & Roloc TSM®

PREMIUM ALUMINUM OXIDE

Size	Grit	Part No. 1-613-	Reg. Net Price/Ea.	NOW! Price Ea.	
2"	100/box	36	-11111	\$.78	\$.70
		40	-11112	.75	.68
		50	-11113	.73	.66
	60	-11114	.70	.63	
		80	-11115	.69	.62
		100	-11116	.67	.60
120	-11117	.67	.60		
180	-11119	.67	.60		

FEATURES:

- General purpose grinding aid and aggressive stock removal.
- Deburring, edge breaking, surface leveling.
- Mold and cavity grinding.

APPLICATIONS:

- Weld removal - Use grits 36-60.
- Blending of pits, gouges, and surface imperfections - Use grits 80-120.
- Achieve various finish gradients - Use grit 180.

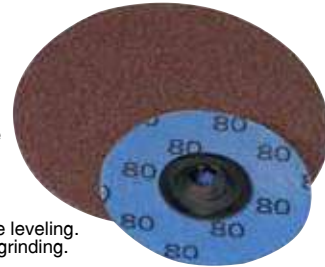

TYPE "S"

SUPERIOR 2" SHUR-KUT® Ceramic Grinding Aid & Quick Change Discs

Equal to Lockit®, PowerLock III®, & Roloc TR®

100 DISCS PER BOX.

Grit	Part No. 1-613-	Reg. Net Price/Ea.	SALE!
60	-40332	\$.97	\$.87
80	-40333	.94	.85
120	-40334	.93	.84

FEATURES:

- Flexible X-weight polyester backing.
- Sharp grains penetrate stainless steel and alloys.
- Open coating density.
- Additional heat dissipation for high temperature grinding.
- Maximum Speed: 30,000 RPM.
- Extended life and grain retention.

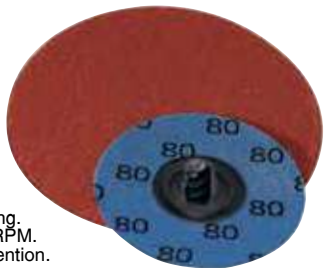

TYPE "R"

SUPERIOR SHUR-KUT® Plate Sanders Stik-On Discs

ALUMINUM OXIDE

Large plate sander discs are heavy duty "X" wt. cloth, coated with a smooth hot melt pressure sensitive adhesive. These discs will not slip or fly off and are easily removed without leaving residue on the backing plates.



Size	Grit	Part No. 1-613-	Reg. Net Price/Disc	SALE!
6"	60	-11459	\$1.57	\$1.33
	80	-11460	1.48	1.26
	100	-11461	1.41	1.20
9"	60	-11489	3.94	3.35
	80	-11490	3.72	3.16
	120	-11492	3.53	3.00
10"	60	-11498	5.00	4.25
	80	-11499	4.72	4.01
	120	-11501	4.57	3.88
12"	60	-11507	6.73	5.72
	80	-11508	6.34	5.39
	120	-11510	6.21	5.28
20"	60	-11555	19.35	16.45
	80	-11556	18.27	15.53
	120	-11558	17.59	14.95

STANDARD ABRASIVES

BriteRite® General Purpose Hand Pads

6" x 9" MAROON ALUMINUM OXIDE

Best for hand application of deburring, polishing, cleaning, finishing and surface preparation on metal composite or plastic surfaces.

Box Qty.	Case Qty.	Part No. 1-631-	Each	ONLY! Ea./Box	Ea./Case
20	60	-827505	\$1.75	\$1.58	\$1.23





Dial Indicator

FEATURES:

- 4-48 Thread.
- Tolerance markers.
- Solid brass housing.
- Popular AGD 2 Series.
- Supplied with lug back.
- Carbide tipped contact points.
- Meets ANSI specs for accuracy.

Part No. **52-520-110** **\$58¹¹**
Reg. Net Price \$89.40



save
35%

SPECIFICATIONS:

Range 1"
Graduation001"
Dial Reading 0-100

Dial Caliper & Indicator Sets

save
20%

SETS INCLUDE:

- Dial Caliper: 0-6".
- Dial Indicator: 0-1".
- Supplied in a fitted plastic case.



Black Face Set
Part No. **8-135-0016** **\$40⁴⁴**
Reg. Net Price \$50.55

White Face Set
Part No. **8-135-0017** **\$40⁴⁴**
Reg. Net Price \$50.55



Universal Magnetic Base

With Fine Adjustment On The Top

FEATURES:

- Five axis holder.
- Instant fixation in any position.
- Fast and easy to set up gauges.
- Universal swivel clamp holds a 6mm, 8mm, 3/8" stem, dovetail or back lug.
- Powerful magnet with ON/OFF switch.
- Central locking mechanism with NOGA designed spring loaded bearing.
- Arm Length: 4.33" Bottom, 3.98" Top.
- Magnetic Pull: 176 lbs./ft.

Model No. DG61003
Part No. **1-457-909** **\$120⁷⁶**
Reg. Net Price \$142.07



Starrett® Dial Test Indicators

Series 3809, 3909

FEATURES:

- Contacts are frictionally adjustable and replaceable.
- Precision gear-driven design with smooth, jeweled movement.
- 3 dovetail positioning mounts.
- Contact point reverses automatically, maintaining clockwise hand rotation.
- Meets or exceeds ANSI/ASME accuracy specifications.

Supplied with a case.

SPECIFICATIONS:

Range030"
Graduation0005"
Dial Readings 0-15-0

Starrett #3809A

Dial Diameter: 1-1/4"
Part No. **1-855-12333**
Reg. Net Price \$147.00
\$124⁹⁵

Starrett #3909A

Dial Diameter: 1-9/16"
Part No. **1-855-12527**
Reg. Net Price \$162.00
\$137⁷⁰



INCLUDES:

- Indicator.
- (2) Contact Points: .156".
- (2) Dovetail Clamps: 3/8" & 5/32".

1" Dial Indicator & Magnetic Base Combo Kit

INDICATOR FEATURES:

- White dial face.
- Revolution counter.
- Graduation: .001".
- .100 per revolution.
- Dial Reading: 0-100.



MAGNETIC BASE FEATURES:

- Overall Height: 9".
- Base: 2-5/8" x 2".
- Permanent magnetic type on/off switch makes it easy to rest on iron or steel.
- With fine adjustment and 130 lbs. of pull.

Supplied in a fitted case.

Part No. **8-100-005F** **\$33⁹⁶**
Reg. Net Price \$39.95



2 Pc. Set-Up & Inspection Kit

OVERSTOCK SALE!
Quantities Limited.

KIT INCLUDES:

- Test Indicator: .030 x .0005".
- Test Indicator Holder: 1-7/8".
- (2) Stems: 5/32" & 3/8".

Supplied with a fitted plastic case.



White Face Kit
Part No. **8-135-0014** **\$49⁹⁵**
Reg. Net Price \$68.70



XTRA-VALUE CAL

0-6" Electronic Caliper

save
20%



FEATURES:

- Direct inch/metric conversion.
- 4-way measurement.
- Stainless steel frame.
- Large easy-to-read display.
- Resolution: 0.0005" (0.01mm).
- Absolute/incremental measurement.

Range: 0-6"
Part No. **54-101-150**
Reg. Net Price \$68.24
\$54⁵⁹

Precision Parallel Set

Matched Pairs 5 Holes

SIZES INCLUDED:

- 3/16" x 1" x 6"
- 3/16" x 1-1/4" x 6"
- 1/2" x 1-1/2" x 6"
- 1/2" x 1-3/4" x 6"

Part No. **1-801-210**
Reg. Net Price \$58.90

\$44¹⁸



FEATURES:

- Hardness: Case hardened to RC 55-62 on 2 sides top and bottom only.
- Dimensions: Within 0.001" allowance.
- Made from fine quality tool steel stress relieved against distortion, precision ground and hardened.
- Tolerance: Parallel 0.0003" on 2 sides, top and bottom.
- The holes are designed for easier handling and set-ups.

save
25%



iGAGING® iP54 ABS Heavy Duty Digital Calipers

Inch/Metric Conversion w/ SPC Output

FEATURES:

- Nib size: 0.800".
- Resolution: 0.0005" (0.01mm).
- Absolute encoding technology memorize absolute origin zero.
- IP54 - Splash water, oil and dust resistant.
- Ultra-response, unlimited measuring speed.
- Heavy duty stainless steel frame.
- High contrast LCD display.
- Fine adjustment screw.
- CR2032 Battery included.

These calipers use super high accuracy Absolute memory technology. They keep track of its origin position once set. Whenever the digital calipers turn on, the easy-view large LCD displays the actual sensor position ready to start measuring. Not necessary to reset zero. High quality surface finish for extra smooth slider movement.

NEW!

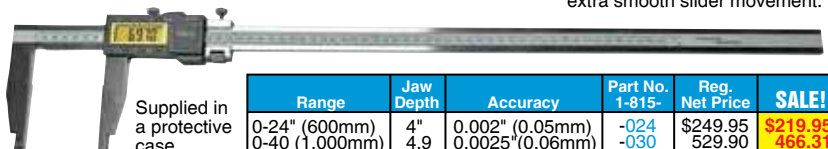

Supplied in a protective case.

Range	Jaw Depth	Accuracy	Part No. 1-815-	Reg. Net Price	SALE!
0-24" (600mm)	4"	0.002" (0.05mm)	-024	\$249.95	\$219.95
0-40" (1,000mm)	4.9"	0.0025" (0.06mm)	-030	529.90	466.31



6" Extended Range Dial Bore Gage Set

NEW!

save 25%

FEATURES:

- Accuracy: 0.0005" with crisp precision graduations.
- Carbide tip on plunger.
- Full set of attachments and parts included.



Supplied in a protective case. **1 YEAR WARRANTY**



Range: .7-6" (up to 10" deep)
Part No. **1-815-400**
Reg. Net Price \$171.88 **\$128⁹¹**

iGAGING EZ-View DRO Plus Digital Scales

With Remote Readout

Horizontal or Vertical with SPC/USB Data Output

Designed specifically for convenient display of any axis of a machine tool movement. Can be mounted on almost any surface, offering the user precise linear measurement capabilities. Precise depth control floating zero allows you to set "zero" anywhere within operating range with a push of a button.

FEATURES:

- Resolution: 0.0005"/0.01mm/Fraction interchangeable 1/32", 1/64", 1/128".
- Remote cable length: 76".
- Articulating arm allows for stacking multiple displays.
- Includes mounting brackets.
- 3-Volt CR2032 Battery.



Range	Accuracy	Distance Between Mounting Brackets	Part No. 1-815-	Reg. Net Price	SALE!
0-6" (150mm)	.002" (0.051mm)	11-1/4"	-750	\$43.63	\$37.09
0-12" (300mm)	.004" (0.102mm)	17-1/4"	-755	54.55	46.37
0-24" (508mm)	.008" (0.203mm)	29-1/4"	-760	76.39	64.93
0-36" (800mm)	.013" (0.033mm)	41-1/4"	-765	87.31	74.21

[Click here for complete details.](#)

Mitutoyo 0-1" Dial Indicator

Continuous Dial with Lug Back Series 2
Inch (ANSI/AGD)

FEATURES:

- A revolutionary offset spindle bushing design provides trouble-free stem clamping and a longer clamping range.
- Unique shock-proof mechanism protects against shock from sudden spindle retraction.
- Greater rigidity in the bearing plate reduces retracing error by up to 20%.
- 4-Screw mounting increases impact resistance for better, longer accuracy.
- No through screw hole on the frame provides better dust resistance.
- Contact point is carbide tipped for lasting accuracy, durability.
- Manufactured to meet ANSI/AGD standards.

Part No. **1-808-2416A**
Reg. Net Price \$140.00
\$119⁰⁰



Supplied in a fitted plastic case.

SPECIFICATIONS:

Dial Diameter 2-1/4"
Per Revolution 0.10"
Graduation 0.0010"
Dial Reading 0-100

Mitutoyo 6 Pc. Telescoping Gage Set

Series 15

FEATURES:

- Satin chrome finish.
- Uniform contact pressure.
- Available individually or in sets.
- Plunger of gages expand from the center, under spring tension, to size of hole being measured and then locked in place by knurled knob. Measurement then made by a micrometer or a vernier caliper.

Range: .313" to 6.00"
Part No. **1-808-155903**
Reg. Net Price \$241.00
\$204⁸⁵



Mitutoyo 0-3" Outside Micrometer Set

Series 103

FEATURES:

- Carbide faces.
- Positive locking clamp.
- Baked-enamel finished frame.
- Clear graduations on satin-chrome finish.
- Ratchet stop or friction thimble for exact repetitive readings.

Set Includes				Part No. 1-808-	Reg. Net Price	SALE!
Range	Grad.	Mitutoyo No.	Remarks			
0-1"	.0001"	103135	Friction Thimble			
1-2"	.0001"	103136		-103922	\$509.00	\$432.65
2-3"	.0001"	103217	Ratchet Stop w/ Standard			



Supplied with a fitted carrying case.

Mitutoyo ABSOLUTE Coolant Proof Calipers

Series 500 with ABSOLUTE Encoder

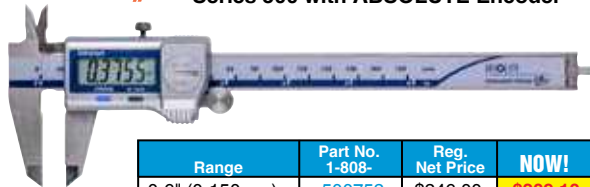

Range	Part No. 1-808-	Reg. Net Price	NOW!
0-6" (0-150mm)	-500752	\$246.00	\$209.10
0-8" (0-200mm)	-500753	330.00	280.50
0-12" (0-300mm)	-500754	571.00	485.35

FEATURES:

- Resolution: .0005" (.01mm).
- IP67 means it's immune to coolants, dirt, grit, and chips.
- Certificate of inspection provided on 6" model.
- No SPC Output.



Mitutoyo Dial Bore Gages

Series 511

FEATURES:

- Interchangeable anvils and necessary accessories to perform close tolerance I.D. measurements.
- A digimatic Indicator can be attached in place of the dial gage.
- Accuracy: .0002" (5µm)
- Carbide ball contact point for durability.
- Optional extension rods can be attached.

2923SB-10 INDICATOR FEATURES:
Range05"
Graduation0001"
Dial Reading 0-5-0

Range	No. of Anvils	No. of Spacers	Probe Depth	Part No. 1-808-	Reg. Net Price	SALE!
.70-1.4"	9	2	4"	-511751	\$486.00	\$413.10
1.40-2.5"	6	4	6"	-511752	473.00	402.05
2.00-6.0"	11	4	6"	-511753	517.00	439.45



Mitutoyo

PRECISION EQUIPMENT SALE

SAVE UP TO 15% OFF
Height Gages, Full-Flex Rules,
Laser Scan Micrometers,
Dial & Vernier Calipers, & More!

SAVINGS END 6.30.24!

Spring 2024



0-6" Economy Depth Micrometer

FEATURES:

- Graduation: .001"
- Satin chrome finish.
- Rod Diameter: 0.176"
- Base surface hardened, ground and lapped.
- Ratchet thimble.
- Locking clamp
- Base Length: 4".



Part No. 52-225-116
Reg. Net Price \$209.50

\$136¹⁸



Supplied with a shop hardened case.

2-4-6 Block Pairs



FEATURES:

- Precision ground & hardened on all sides.
- Ideal for mounting work for precision grinding and layout.
- 23 holes: 5 are tapped 5/8"-11, the other 18 are untapped.
- Parallelism $\pm .0005"$.
- Hardness HRC 56-60.

2" x 4" x 6"

Part No. 1-806-002

Reg. Net Price \$141.00

\$119⁸⁵

4 Pc. Combination Square Set



GRADUATIONS:

1.0mm/64ths, .05mm/32nds

FEATURES:

- Used for layouts, set-ups, checking heights, depths, and setting angles, etc.
- Square head has a level and scribe.
- Square head, center head, and protractor hardened and ground.
- Hardened and tempered blade with satin chrome finish.

12" Blade

Part No. 1-812-001

Reg. Net Price \$59.99

\$47⁹⁹

MACHINIST'S MATE Electronic Edge Finder



Self-Contained Visual For Machine Set-Up.

FEATURES:

- Finder lights up instantly when stylus 0.200" dia. x 1/2" length reaches the work edge.
- Exact reading off any electrically conductive metal with clean surface.
- Shank: 1/2" dia., Length: 3-15/16".
- Accuracy: 0.0005".
- Includes: (1) "AAA" Alkaline battery, (1) Bulb in a protective tube.

Part No. 1-275-98315

Reg. Net Price \$42.40

\$36⁰⁴

25 Pc. Precision Radius Gage With Handle

FEATURES:

- Satin chrome finish.
- Five measuring surfaces for both convex and concave radii.
- Designed for checking or laying out concave or convex radii.
- Used for inspection, layout, pattern making and all other machining jobs.
- Each gage is marked clearly with its size.

Supplied in a fitted case.

Tool No. RG1
Size Range: 1/64" - 17/64" by 64ths and 9/32" to 1/2" by 32nds.

Part No. 8-410-009

Reg. Net Price \$42.90

\$34³²



Starrett® Precision Steel Minus Pin Gage Sets

FEATURES:

- Gages are 2" long and hardened to RC 60/72.
- Pin gages are manufactured to a 0.0002" tolerance.
- All sharp corners are broken.
- Each pin is centerless lapped and is clearly etched with the stated size.
- Color coded, fully adjustable GO/NO-GO gage handle furnished with each set.
- Inspection certificate included.

Supplied in a rugged, high-impact protective case (each space marked for appropriate gage).



Click here for complete details.

Description	Starrett No.	Part No. 1-855-	Reg. Net Price	NOW!
50 Pc. Set, Sizes .011-.060"	S4001-060	-67481	\$125.00	\$106.25
190 Pc. Set, Sizes .061-.250	S4003-250	-67483	278.00	236.30
250 Pc. Set, Sizes .251-.500	S4005-500	-67485	424.00	360.40

FISHER MACHINE Thread Measuring Wire Set

FEATURES:

- For measuring all 60° threads.
- Utilizes the three wire system of measuring external threads, accepted as the most accurate method.
- Measures all 60° threads from 3 to 48 TPI, and all metric threads from .5 to 6mm pitch.

SET INCLUDES:

- 48 wires, in 16 different sizes.

Part No. 1-811-131

Reg. Net Price \$50.40

\$42⁸⁴



Chamfer Gage

Instantly measures top diameter of tapered holes!

The chamfer gage is a precision instrument designed specifically to measure the top (major) diameter of a chamfer, countersink, center drill, or tapered hole. Merely press the spring loaded, conically ground, precision 3-blade Gaging Plunger into the chamfer or countersink and instantly read the dial in .001" or .1mm/.01mm diameter increments. The chamfer gage is a direct reading gage. No Setting Master (Standard) or look-up chart is required. **ACCURACY:** Within .001" in 0°-90°.



SPECIFICATIONS:

Angle Range 0°-90°
Size Range 0-1"

Part No. **1-819-1090** **\$193³⁸**
Reg. Net Price \$227.50

0-1" IP65 Twin-Force Digital Micrometer



Supplied with a protective case.

SPECIFICATIONS:
Resolution00005" (.001mm)
Range..... 0-1" (0-25mm)
Accuracy ±.00015"

Part No. **1-815-531**
Reg. Net Price \$109.10
\$87²⁸

FEATURES:

- Micro USB data output.
- Ball attachment included.
- (1) 3V CR 2032 battery.
- Twin-force movements: Friction and Ratchet.
- Black anodized friction tube for easy grip and easy clean.
- IP65 Water and dust protective reading.

4 Pc. V-Blocks Set With Clamps



FEATURES:

- 90° V with 45° even on each side.
- Chrome and hardened steel.
- Ground to 0.0005".
- Parallel on all sides.
- Supplied complete with zinc die cast clamps.

SET INCLUDES:

- (2) 1-1/4 x 1-1/4 x 1-5/8"
- (2) 2" x 1-1/2 x 1-1/2"

Supplied with a heavy-duty fitted case.

Part No. **1-815-700** **\$79⁹⁵**
Reg. Net Price \$100.36



iP54 EZ Absolute Digital Height Gauges

FEATURES:

- iP54 Protective Rating – Moisture & dust resistance.
- Absolute encoding technology memorize absolute origin zero.
- Ultra-response measure speed.
- Resolution: 0.0005" (0.01mm).
- Indication Variability: 0.0005" (0.01mm).
- Zero setting at any position.
- Large LCD display.
- Inch/Metric conversion at any position.
- Indicator bar for travel included.
- Single stainless steel beam with light weight construction.
- Carbide tipped scriber.
- Micro USB data output port.
- Auto power off.
- Supplied in a protective case.

Range	Accuracy	Part No. 1-815-	Reg. Net Price	SALE!
0-12" (300mm)	0.002" (0.04mm)	-645	\$218.39	\$174.71
0-24" (600mm)	0.002 (0.05mm)	-665	293.90	235.12

Replacement Battery 3-Volt Type CR2032
Part No. **1-541-358** Reg. Net Price **\$2.98**



Plastic Thickness Gage Sets

13 THICKNESSES

5" Fan Blade Set
Part No. **1-958-78905**
Reg. Net Price \$38.25

\$32⁵¹

12" Fan Blade Set
Part No. **1-958-78900**
Reg. Net Price \$59.11

\$50²⁴



Decimal/Metric	Color
.001" (.025mm)	Amber
.0015" (.038mm)	Purple
.002" (.051mm)	Red
.003" (.076mm)	Green
.004" (.102mm)	Tan
.005" (.127mm)	Blue
.0075" (.191mm)	Matte
.010" (.254mm)	Brown
.0125" (.305mm)	Black
.015" (.381mm)	Pink
.020" (.508mm)	Yellow
.025" (.635mm)	White
.030" (.762mm)	Coral

FEATURES:

- Contains 13 blades riveted together for on-site convenience.
- Color indicates thickness.
- Made of the highest quality plastic material.
- Non-corrosive, non-conductive, non-sparking, and non-marring.
- Packaged in a vinyl case.

81 Pc. Certified Gage Block Set



Toolroom Grade

SET FEATURES:

- Hardened to 65 RC.
- Tolerance: +/- .000050"
- Meets or exceeds federal spec ASME B89.1.9-2002.
- Manufactured in a controlled environment to ensure accuracy.
- Certificate of calibration traceable to N.I.S.T showing deviation of each block.
- Surface Finish: .4 millionths (.01 microns).

SET INCLUDES:

- 1 Block .05"
- 10 Blocks .1"-.1009" in .0001" Steps
- 49 Blocks .101"-.149" in .001" Steps
- 17 Blocks .15"-.95" in .05" Steps
- 4 Blocks 1"-4" in 1" Steps



NIST Certified
Part No. **2-670-081** **\$166³⁰**
Reg. Net Price \$207.87

Starrett 2-1/2" Solid Rod Inside Micrometer Set Series 124

FEATURES:

- Hardened and ground anvils on rods, adjustable for length.
- Head anvil is hardened and ground.
- Measuring rods are solid and assembled on one side of the micrometer head.
- Rods are insulated and marked with length.
- Quick-reading figures – Every thousandth numbered on inch reading tools.
- Handle screws in the micrometer head in place of dummy screw, which is opposite a rod lock screw.
- Each set includes micrometer head, rods and supplied in a fitted case.

SPECIFICATIONS:

Range2-12"
Graduation001"
No. of Rods 10
No. of Spacing Collars (1) 1/2"
Movement of Screw 1/2"



Starrett No. 124BZ
Part No. **1-855-50546** **\$384²⁰**
Reg. Net Price \$452.00

Starrett Machinists' Improved Levels Series 98 with Ground & Graduated Vials

FEATURES:

- Adjustable to a positive setting.
- Ground and graduated main vials.
- Base of the levels feature an involute groove running the length of base, providing a reliable seat for round work.
- With the cross test level, it's possible to simultaneously level in both directions.



Size		Description	Starrett No.	Part No. 1-855-	Reg. Net Price	SALE
Inch	mm					
8"	200	With Cross Test Vial	98-8	-50442	\$229.00	\$201.52
12	300	With Ground Single Plumb Vial and Cross Test Vial	98-12	-50443	317.00	278.96



Radial Drill Press
With 39" Arm
3 HP, 230/460V, 3 PH Motor
**Box Table, Coolant System
and Work Light Included!**

Model RD-1000
Part No. 6-269-011
\$13,500⁰⁰

SPECIFICATIONS:
Dist. Spindle to Column 39.4"
Spindle Taper 4 MT
Quill Travel 9-7/8"
Column Diameter 10"
Drilling Capacity 1-1/2"
Overall Height 93"

AS LOW AS
\$310.50/mo.



20-1/2" Floor Drill Press

1-1/2 HP, 115/230V, 1 PH Motor

FEATURES:

- Rotating ± 45° tilting, crank-operated worktable with quick-release clamp.
- 1/2" diameter external positive depth stop with 3-nut locking feature.
- Hinged metal belt and pulley cover.
- Adjustable tension spindle return spring.
- Quick adjustment motor mount.
- Spindle supported by high quality ball bearings.

SPECIFICATIONS:

Swing 20-1/2"
Drilling Capacity 1"
Spindle Taper 3 MT
Spindle Travel 4-5/8"
Dist. Spindle to Table 29-1/8"
Speeds (12) 150-4,200 RPM

Model JDP-20MF
Part No. 6-200-039
\$2,186²⁰

COMPLETE WITH:

Built-in work lamp, t-slot table with coolant through, and 3/4" capacity drill chuck and key.



Gear Head Drill Press

1-1/2 HP, 230V, 3 PH Motor

FEATURES:

- 2-speed instant reversing motor for tapping.
- X & Y table movement with graduated dials.
- Up to 24" capacity spindle - table.
- Gear head direct-drive of spindle.
- Rapid and fine manually operated quill feeds.

COMPLETE WITH:

Rear rubber way cover, 2-axis t-slot work table, geared head spindle drive, and graduated dials for X & Y handwheels.

SPECIFICATIONS:

Swing 22-1/2"
Column Diameter 4-1/2"
Table Size 7-1/2" x 23-3/4"
Table Travel 7-1/2" x 14-1/2"
Spindle Travel 4-3/4"
Spindle Taper 4 MT
Drilling Capacity (in mild steel) 1-1/2"
Spindle Speeds (6) 9-1,970 RPM

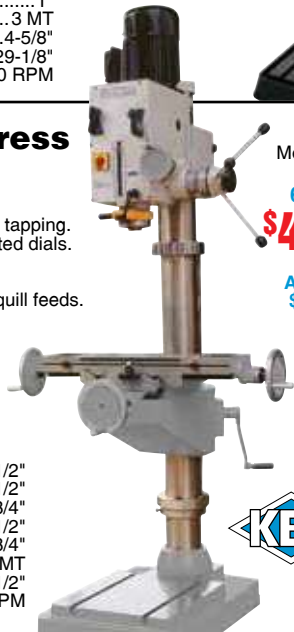

Model GHD-40
Part No. 6-325-015
\$4,265⁰⁰

AS LOW AS
\$98.10/mo.



24" Geared Head Drill Press

1-1/2 HP, 230V, 3 PH Motor

SPECIFICATIONS:

Swing 24"
Drilling Capacity 1-1/2"
Spindle Taper 4 MT
Spindle Travel 6-5/8"
Dist. Spindle to Column Face 12"
Dist. Spindle to Table 32-1/2"
Dist. Spindle to Base 47"
Column Diameter 5-1/2"
Table Size 20" x 16"
Motor 3/4/1.5 HP; 1,700/3,400 RPM
230V, 3 PH
Speeds (8) 80-950 RPM

Model 600B
Part No. 6-325-005
\$6,565⁰⁰

AS LOW AS
\$151.00/mo.

FEATURES:

- Foot pedal operated instant reverse switch for tapping.
- Power quill feed.
- T-slot table with coolant through.

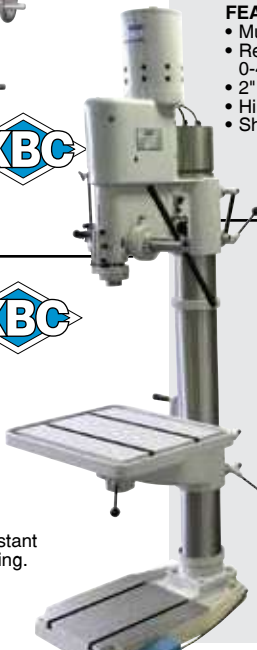

nova™ 16" Nova Viking DVR Drill Press

1 HP, 120V, 1 PH Motor

FEATURES:

- Digital Variable Reluctance (DVR) Direct Drive Technology with Adaptive Control™ Software which works for you to produce optimum results in wood, metal, plastic and glass.
- Intelligent speed selection and dial knob for precise speed adjustments.
- Automatic electronic depth stop, quickly and accurately stops to the precise programmed depth.
- Electronic braking and forward/reverse.
- Convenient LED light and twin laser guide system.



Model 83705
Part No. 6-125-075
\$1,449⁰⁰

SPECIFICATIONS:

Chuck Size 5/8"
Drilling Capacity 5/8"
Swing 16"
Spindle Taper 2 MT
Speeds (Var.) .. 150-3,000 RPM

COMPLETE WITH:

5/8" Drill chuck & key, firmware USB cable, knock-out wedge, adjustment wrench, and hex keys.



[Click here for complete details.](#)



Disc & Belt Sander With Floor Stand



FEATURES:

- 9" disc & 6" x 48" belt.
- Table can be switched from disc side to belt side and tilts 45° R&L.
- Can be switched horizontal to vertical.

NOTE: Shipped partially assembled.

SPECIFICATIONS:

Belt Size 6" x 48"
Belt Speed 2,300 SFPM
Disc Size 9"
Disc Speed 3,000 RPM
Motor 3/4 HP, 115V, 1 PH



Model 9648
Part No. 6-150-005
\$525⁰⁰

KALAMAZOO 2" Belt Sander
1/2 HP, 115V, 1 PH Motor

FEATURES:

- Multi-position sanding head.
- Removable and adjustable 0-45° steel work table.
- 2" x 48" Belt.
- Hinged guard for quick belt change.
- Shipping Weight (approx.): 50 lbs.



Part No. 2-002-2FSM **\$649⁰⁰**



PALMGREN 12" Disc Abrasive Finishing Machine

Ideal for finishing outside radius of metal, wood, plastics, and composite materials.

FEATURES:

- Direct drive.
- 45° tilting table.
- Miter gauge.
- 2" Dust collection port.

SPECIFICATIONS:

HP 3/4 HP
Voltage 120V
Max. Speed 1,720 RPM
Table Size 17-1/4" x 8-3/8"

Part No. 1-549-81312 **\$378⁰⁰**



TENNSMITH

Universal Box & Pan Brake

With Stand

F.O.B. FACTORY
— TENNESSEE

AS LOW AS
\$121.67/mo.

Model HBU48-12
Part No. 6-700-045
\$5,290⁰⁰

Model HBU48-16
Part No. 6-700-040
\$2,135⁰⁰

Model HBU48-22
Part No. 6-700-035
\$1,405⁰⁰



SPECIFICATIONS:	HBU48-22	HBU48-16	HBU48-12
Capacity (mild steel).....	22 GA.	16 GA.	12 GA.
Bending Length.....	48-1/4"	48-1/4"	48-1/4"
Max. Depth of Body.....	3"	4"	4"
Max. Lift of Beam.....	7/8"	1-1/4"	1-1/2"
Front to Rear Beam Adjustment.....	1/8"	5/8"	1"
Min. Reverse Bend.....	5/16"	1/4"	1/4"
Min. Flange in Cap. Material.....	3/8"	1"	1"
Finger Widths.....	2, 3 & 4"	2, 3 & 4"	2, 3 & 4"

TENNSMITH

16 Gauge Foot Squaring Metal Shears

Model 36
Part No. 6-700-005
\$3,075⁰⁰

Model 52
Part No. 6-700-010
\$3,845⁰⁰



- FEATURES:**
- Max. Shearing Capacity (mild steel): 16 GA.
 - Max. Shearing Capacity (stainless steel): 20 GA.
 - Back Gauge Range: 30"
 - Front Gauge Range: 37"

F.O.B. FACTORY
— TENNESSEE



SPECIFICATIONS:	MODEL 36	MODEL 52
Maximum Cutting Length.....	37"	52-1/4"
Floor Space, Gauges in Position.....	45" x 80"	60" x 80"
Overall Dimensions, Less Gauges, L x W x H.....	46-1/2" x 27" x 42"	61" x 36" x 42"

7" x 18" Vertical Bench Mill

2 HP, 115V, 1 PH Motor

FEATURES:

- Reversing switch.
- Manual quill feed both rapid spoke wheel and fine feed handwheel control with an easy to read, front mounted depth gage.
- Dovetail ways on table and saddle with adjustable tapered gibs.
- Head assembly is raised and lowered on the column by a crank. The head pivots 360° on the column and can be locked in any position.

Model GRIP-16
Part No. 6-275-003 **\$2,750⁰⁰**

SPECIFICATIONS:	
Drilling / End Mill Capacity.....	1-1/4" / 3/4"
Swing.....	15-7/8"
Max. Distance, Spindle to Table.....	18"
Spindle Taper / Travel.....	R8 / 5"
Spindle Speeds (12).....	110-2,385 RPM
Table / Cross Slide Travel.....	18" / 7"
Effective Table Area.....	28" x 8"
Overall Height.....	43-1/2"



COMPLETE WITH:
FREE floor stand, drawbar for R8 collets, and front and rear rubber way covers.

9" x 49" Turret Milling Machines

3 HP, 230/460V, 3 PH Motor

SPECIFICATIONS:

Table Size.....	9" x 49"
Longitudinal Travel Manual Model.....	35"
Longitudinal Travel with Power Feed.....	31"
Cross Travel.....	12"
Knee Travel.....	16"
Table to Spindle (min.-max.).....	0-18-3/4"
Spindle to Column at 90°.....	6-3/4" - 18-3/4"
Spindle Speeds (Var.).....	70-4,200 RPM
Spindle Taper.....	R8
Power Quill Feeds (per rev.).....	0.0017/.0032/.0053
Quill Travel.....	5"

Model TUM-1VS
Part No. 6-265-007
\$9,245⁰⁰
With NEWALL NMS-300 DRO & Table Feed Installed
Part No. 6-265-007-N3 **\$11,355⁰⁰**
AS LOW AS \$212.64/mo.



3 HP Variable Speed Head!

NEWALL NMS-300 2-Axis Digital Readout

6" x 26" Vertical Milling Machine

1 HP, 115V, 1 PH Motor

FEATURES:

- Dovetail ways with adjustable tapered gibs under the table and saddle 7 on the column face.
- Spindle feeds with a manually operated rapid feed lever or a fine feed handwheel.
- Turret head tilts to either side 90° and swivels 120° right or left. R8 taper spindle accepts all common R8 tooling.

Model VM-12-R8
Part No. 6-380-001 **\$4,200⁰⁰**
AS LOW AS \$96.60/mo.

SPECIFICATIONS:	
Spindle Taper.....	R8
Quill Travel.....	2-3/4"
Spindle Speeds (9).....	230-2,520 RPM
Longitudinal Travel.....	14-1/2"
Cross Travel.....	6"
Table Size.....	6" x 26"

COMPLETE WITH:
FREE floor stand, work light, front and rear rubber way covers, cabinet floor stand, and drawbar for R8 collets.

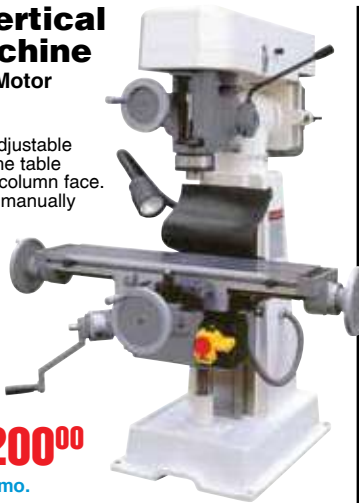

10" x 54" Heavy-Duty Milling Machines

SPECIFICATIONS:

	TUM-3VS	TUM-40VS
Table Size.....	10" x 54"	10" x 54"
Longitudinal Travel Manual.....	32"	32"
with Power Feed.....	28"	28"
Cross Travel.....	16"	16"
Knee Travel.....	16"	16"
Spindle Speeds.....	70-4,200 RPM	70-4,200 RPM
Spindle Taper.....	R8	NST40
Quill Travel.....	5"	5"
Spindle Motor.....	3 HP, 3 PH	5 HP, 3 PH
Voltage.....	230/460V	230/460V

Model TUM-3VS (230V, 3 PH)
Part No. 6-265-006
\$10,200⁰⁰

With NEWALL NMS-300 DRO & Table Feed Installed
Part No. 6-265-006-N3 **\$12,080⁰⁰**

Model TUM-40VS (230V, 3 PH)
Part No. 6-265-009
\$12,500⁰⁰

With DRO & Table Feed Installed
Part No. 6-265-009-N3 **\$14,480⁰⁰**



MODEL TUM-40VS
5 HP Motor, #40 NST Spindle Taper, Hardened & Ground Square Ways on Knee and Column.



MODEL TUM-3VS Shown with Newall NMS-300 and KBC Table Feed.

AS LOW AS \$234.60/mo.



6" x 18" Surface Grinder

2 HP, 230V, 3 PH Motor

COMPLETE WITH:
6" x 18" Permanent magnetic chuck, 1-shot lubrication system, and flood coolant system.

Model KGS-618M
Part No. 6-273-003

\$12,000⁰⁰

AS LOW AS \$276.00/mo.

SPECIFICATIONS:

Max. Distance Spindle to Table..... 21"
Spindle Speed..... 3,450 RPM
Table Size..... 6" x 18"
Table Travel..... 8-1/2" x 19-1/2"
Wheel Size..... 8" x 3/4" x 1-1/4"
Item Weight..... 2,500 lbs.

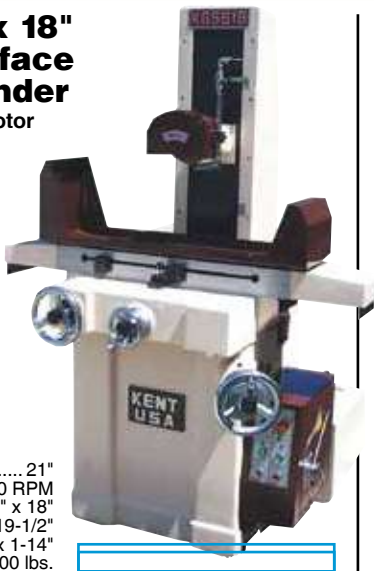

KENT USA 10" x 20" 3-Axis Automatic Surface Grinder

3 HP, 230/460V, 3 PH Motor

COMPLETE WITH: 8" x 20" Permanent magnetic chuck, and flood coolant system with splash guards.

- FEATURES:**
- 3-axis automatic with incremental downfeed and electronic auto crossfeed.
 - Precision cartridge type direct drive spindle (3,500 RPM).
 - Heavy cast iron base absorbs vibration.
 - Automatic lubrication.
 - Wheel Size: 8" x 1" x 1-1/4".

Model KGS-1020AHD
Part No. 6-273-012

\$24,000⁰⁰

AS LOW AS \$541.92/mo.



KENT USA 3-Axis Auto Feed Surface Grinders

AS LOW AS \$711.27/mo.

COMPLETE WITH: Electric chuck, dust-suction coolant, over head parallel dresser, auto lubrication system, wheel balancing base, and arbor.

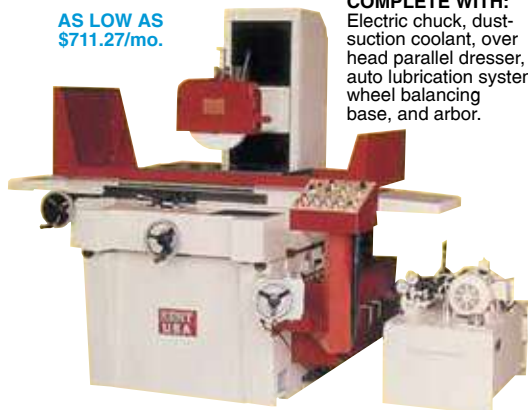

Model SGS-1230AHD (12" x 30" Cap.)
14" x 1-1/4" x 5" Wheel (5 HP, 230/460V, 3 PH)
Part No. 6-273-020

\$31,500⁰⁰

Model SGS-1640AHD (16" x 40" Cap.)
14" x 2" x 5" Wheel (7-1/2 HP, 230/460V, 3 PH)
Part No. 6-273-025

\$48,000⁰⁰



17" x 40" Heavy-Duty Precision Lathe

7-1/2 HP, 230/460V, 3 PH Motor

FEATURES:

- D1-6 camlock, 3-1/8" spindle bore.
- Centralized lube system in headstock.
- Speeds (12) 36-1,800 RPM.
- Hardened and ground gears and bedways.

Model ML-1740T
Part No. 6-273-064

\$22,000⁰⁰

With NEWALL NMS-300 Digital Readout Installed
Part No. 6-273-064-N3 **\$23,730⁰⁰**
AS LOW AS \$496.76/mo.

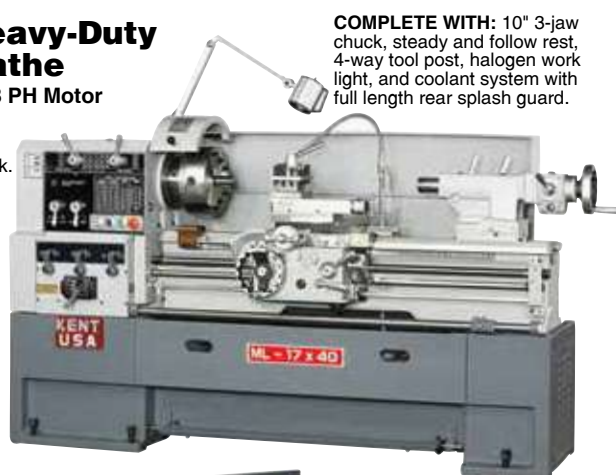

COMPLETE WITH: 10" 3-jaw chuck, steady and follow rest, 4-way tool post, halogen work light, and coolant system with full length rear splash guard.



NEWALL NMS-300 2-Axis Digital Readout



NEWALL DP-700 2-Axis Digital Readout



Large Bore Engine Lathes

10 HP, 230/460V, 3 PH Motor

FEATURES:

- 10 HP main spindle motor, 12 speeds.
- Centralized lube system in headstock.
- Hardened and ground gears and bedways.
- D1-8 camlock, 4.12" spindle bore.
- Jog button, 4-way rapid traverse.
- Inch dials and leadscrews.
- Clutch style headstock.
- Safety foot brake.

COMPLETE WITH:

- 12" 3-Jaw chuck, 16" 4-jaw chuck, work light, 8" steady rest, 1-3" follow rest, 4-way tool post, thread chasing dial, full-length splash guard, and coolant system.

AS LOW AS \$575.79/mo.

SPECIFICATIONS:

Swing Over Bed 22" / 26"
Swing Over Cross Slide 12.5" / 16.5"
Distance Between Centers 60" / 80" / 120"
Spindle Speed (Range 12) 36-1,600 RPM
Spindle Nose / Bore D1-8 / 4.12"
Threads Standard (32) 2-28 TPI
Threads Metric Pitch (22) 1-14mm
Tailstock Quill Travel/Taper 6" / 5MT



Model KLS-2260C (22" x 60")
Part No. 6-273-067

\$25,500⁰⁰

With NEWALL NMS-300 Digital Readout Installed
Part No. 6-273-067-N3 **\$27,350⁰⁰**

Model KLS-2280C (22" x 80")
Part No. 6-273-068

\$26,500⁰⁰

With NEWALL NMS-300 Digital Readout Installed
Part No. 6-273-068-N3 **\$28,650⁰⁰**

Model KLS-26120C (26" x 120")
Part No. 6-273-069

\$32,000⁰⁰

With NEWALL DP-700 Digital Readout Installed
Part No. 6-273-069-N **\$37,600⁰⁰**

22" x 120" Toolroom Lathe

10 HP, 230V, 3 PH Motor



COMPLETE WITH: 3- & 4-Jaw chucks, steady and follow rest, 4-way toolpost, and coolant system with full length rear splash guard.

FEATURES:

- 10 HP spindle motor, 12 speeds.
- D1-8 camlock, 4-1/8" spindle bore.
- Inch dials and leadscrews.
- Full length safety foot brake.
- Thread chasing dial.
- 2-way rapid traverse.
- Solid cast base.

Save Over! **\$2,775.00**



Model GRIP-22120G
Part No. 6-269-017
Reg. Net Price **\$27,750.00**

\$24,975⁰⁰

AS LOW AS \$563.94/mo.

SPECIFICATIONS:
Swing Over Bed / Carriage ... 22" / 14"
Center Distance 120"
Spindle Speeds (12) 25-1,500 RPM
Thread Cutting Range
Inch (60) 2-112 TPI
Metric (41) 0.1-14 mm
Tailstock Taper 5 MT
Drive Motor 10 HP, 230V, 3 PH



13" x 40" Precision Toolroom Lathe

2 HP, 230V, 1 PH Motor



FEATURES:

- 13" swing x 40" between centers.
- 8 spindle speeds, 70-2,000 RPM.
- D1-4 spindle mount, 1-1/2" bore.
- Floor model with full-length rear guard.

Model GRIP-1340G
Part No. 6-269-008

\$7,200⁰⁰

With NEWALL NMS-300 Digital Readout Installed
Part No. 6-269-008-N3 **\$9,080⁰⁰**

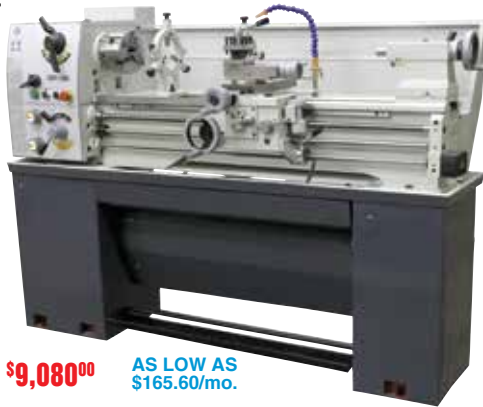

AS LOW AS \$165.60/mo.

16" x 40" Precision Toolroom Lathe

6 HP, 230V, 3 PH Motor



FEATURES:

- Large 2" spindle bore.
- 16" swing x 40" between centers.
- 16 spindle speed, 45-1,800 RPM.
- D1-6 camlock spindle with 3-point bearing.

Model GRIP-1640GH
Part No. 6-269-009

\$12,200⁰⁰

With NEWALL NMS-300 Digital Readout Installed
Part No. 6-269-009-N3 **\$14,080⁰⁰**



AS LOW AS \$280.60/mo.

NEWALL NMS-300 2-Axis Digital Readout



14" x 40" Precision Toolroom Lathe

3 HP, 230V, 3 PH Motor



Model GRIP-1440G
Part No. 6-269-006

\$9,200⁰⁰

With NEWALL NMS-300 Digital Readout Installed
Part No. 6-269-006-N3 **\$11,080⁰⁰**



AS LOW AS \$211.60/mo.

SPECIFICATIONS:

- Swing Over Bed 14"
- Swing Over Carriage 8-3/4"
- Center Distance 40"
- Spindle Mount/Bore D1-4/1-1/2"
- Spindle Speeds (16) 45-1,800 RPM
- Thread Cutting Range
Inch (44) 4-112 TPI
- Metric (22) 0.45-7.5 mm
- Tailstock Taper 3 MT
- Drive Motor 3 HP, 230V, 3 PH (2 Speed)

COMPLETE WITH:
Foot brake, 3- & 4-jaw chucks, steady and follow rest, work light coolant system, and splash guard.



High Precision Engine Lathes



AS LOW AS \$429.02/mo.

FEATURES:

- 7.3 HP main spindle motor, 12 speeds.
- D1-8 camlock, 3.2" spindle bore.
- Solid one-piece cast iron base.
- Hardened and ground gears and bedways.
- Centralized lube system in headstock.
- Full-length safety foot brake.
- Inch dials and leadscrews.

COMPLETE WITH: 8" 3-Jaw chuck, 10" 4-jaw chuck, 4-way tool post, steady and follow rest, halogen work light, and coolant system with full length rear splash guard.

Model KLS-1840G (18" x 40")

Part No. 6-273-070
\$19,000⁰⁰

With NEWALL NMS-300 Digital Readout Installed
Part No. 6-273-070-N3 **\$20,730⁰⁰**

Model KLS-1860G (18" x 60")

Part No. 6-273-071
\$20,500⁰⁰

With NEWALL NMS-300 Digital Readout Installed
Part No. 6-273-071-N3 **\$22,400⁰⁰**

18" x 60" Toolroom Lathe

7-1/2 HP, 230V, 3 PH Motor



FEATURES:

- 7-1/2 HP spindle motor, 12 speeds.
- D1-8 camlock, 3-1/8" spindle bore.
- Inch dials and leadscrews.
- Full length safety foot brake.
- Thread chasing dial.

Model GRIP-1860G
Part No. 6-269-014

\$19,350⁰⁰

AS LOW AS \$436.92/mo.



COMPLETE WITH: 3- & 4-Jaw chucks, steady and follow rest, 4-way tool post, and coolant system with full length rear splash guard.

SPECIFICATIONS:

- Swing Over Bed / Carriage 18" / 10-3/4"
- Center Distance 60"
- Spindle Speeds (12) 25-1,700 RPM
- Thread Cutting Range
Inch (60) 2-112 TPI
- Metric (41) 0.1-14 mm
- Tailstock Taper 4 MT
- Drive Motor 7-1/2 HP, 230V, 3 PH



Jaws 55 Ton Punch Pressure Ironworker

5 HP, 230V, 3 PH Motor

Hydraulic powered punching capacity with open tooling station, built-in stations for shearing plate and angle iron.

SPECIFICATIONS:

- Max. Capacity 1-3/8" Dia. -1/2" Plate
- Largest Standard Punch/Die ... 1-1/16"/1-1/4"
- Bar Shear Rounds/Squares 1-1/8"
- Max. Flat Thickness 3/4" x 4"
- Max. Flat Width 1/2" x 12-3/8" x 14"
- Max. Angle Shear Size 3" x 3" x 3/8"

Call us for punches & dies and all the other available accessories for these versatile machines.



Model 55T Part No. 6-700-215

CALL FOR PRICING!
TOO LOW TO ADVERTISE!

While Supplies Last.



General Purpose Gravity Feed Vertical Bandsaws

3/4 HP, 115V, 1 PH

FEATURES:

- Foot pedal for hands free carriage movement of 4" (100mm).
- C-clamp for clamping of material.
- Ground solid steel table.
- Adjustable material length stop for repetitive cutting.
- Cast iron wheels.
- Roller guides are hardened and grooved allowing use of 1/4", 3/8", 1/2", and 3/4" (6.4, 9.5, 12.7, 19mm) blades without any adjustment.
- Electric system uses only C.S.A./UL approved components and is electrically approved.
- Variable speed drive model installed with end of cut shut-off.
- Instruction and parts manual included.

NEW!

MODEL 115C



Model 115C
Part No. 6-600-115C
\$5,969⁰⁰

Model 115C-VS
Part No. 6-600-115C-VS
\$7,642⁰⁰

AS LOW AS \$137.29/mo.

Includes FREE Stop Set
\$299 Value!
While Supplies Last.



MODEL 115C-VS



12" Lever Shearing Machine



save 25%

Part No. 1-397-1463
Reg. Net Price \$213.84 **\$160³⁸**

FEATURES:

- Long handle provides plenty of shearing torque.
- Ideal machine for shearing metal, sheet, steel, bars, and rods.
- Cuts up to 1/8" steel and stainless steel.
- Hardened and tempered blades.

SPECIFICATIONS:

Blade Length 12"
Handle Length 30"
Net Weight 54 lbs.



14-1/2" Capacity Gravity Feed Vertical Saw

1 HP, 115, 1 PH Motor



FEATURES:

- Rugged simple construction for easy maintenance and long service life.
- Accurate gravity feed with hydraulic speed control and depth stop.

Model EF-1459
Part No. 6-398-005
\$7,795⁰⁰

AS LOW AS \$179.29/mo.

SPECIFICATIONS:

Cutting Capacity (W x H) ... 8-3/4" x 14-1/2"
Table Size 18-1/2" x 30"
Blade Size (L x W) 120" x 1/4"-3/4"
Speeds (4) 70 / 140 / 270 / 525 SFPM
Maximum Blade Travel 9"

18" Variable Speed Vertical Bandsaw

1 HP, 230V, 1 PH Motor

WITH BLADE WELDER



FEATURES:

- Quality construction, built on a solid cast iron frame.
- Built-in blade welder with grinder wheel, work light, chip blower, and blade shear that will weld blades up to the saw capacity.

Model BAV-450
Part No. 6-395-027 **\$5,075⁰⁰**
AS LOW AS \$116.73/mo.

SPECIFICATIONS:

Cutting Height/Width 10"/18"
Blade Size (L x W) 140-1/2" x 1/8" - 5/8"
Table Size 22-1/4" x 19-5/8" x 3/8"
Table Tilt (R x L & F x B) 15°
Dimensions (H x W x D) 80" x 27.5" x 44"
Cutting Speeds (Var.) 82-384 FPM



14" Coldsaw

2 HP, 230V, 3 PH Motor

FREE High Speed Blade Included

FEATURES:

- 14" diameter blade cuts up to 4-1/2" diameter stock.
- 2-speed (18 & 36 RPM) cold saw uses a metal blade to cut burr-free.
- Direct drive oil-filled worm gearbox.
- On/off control switch in handle grip turns on the blade and coolant.

COMPLETE WITH:

Self-centering vise, cabinet base with built-in coolant system, oil filled worm gearbox, 45° swivel of head left and right, and 1 year parts replacement warranty.

AS LOW AS \$101.78/mo.

Model CS-350
Part No. 6-545-006
\$4,425⁰⁰



20" Variable Speed Vertical Bandsaws

WITH BLADE WELDER

Model BAV-500
Part No. 6-396-015
\$7,750⁰⁰

Model BAV-500PF with Table Power Feed
Part No. 6-396-025
\$8,395⁰⁰

Model BAV-700PF with Table Power Feed
Part No. 6-396-035
\$9,295⁰⁰

AS LOW AS \$178.25/mo.



SPECIFICATIONS:

	BAV-500	BAV-500PF	BAV-700PF
Cutting Capacity (W x H)	20" x 14-1/2"	20" x 12-7/8"	28" x 12-5/8"
Blade Size (L x W)	159-1/2" x 1/8"-1"	159-1/2" x 1/8"-1"	161" x 1/8"-1"
Table Height	39"	39"	39"
Table Size	29-1/8" x 26-3/4"	29-1/8" x 26-3/4"	26-3/4" x 29-1/8"
Table Tilt (R x L)	15°	5°	5°
Cutting Speeds FPM (Inf. Var.)	82-1,496	82-1,496	65-1,292
Motor	2 HP, 230/460V, 3 PH	2 HP, 230/460V, 3 PH	2 HP, 230/460V, 3 PH



SHOP FOX **12" Disc & 6" x 48" Belt Heavy-Duty Combination Sander** 1-1/2 HP, 115V, 1 PH Motor

The sander uses a direct ball bearing drive from the motor to the sanding disc and belt deliver a maintenance and vibration free positive torque flow.

FEATURES:

- Precision ground cast iron tables.
- On/off toggle switch with safety key.
- Cabinet style stand with power coated paint.

Model WS1712 **\$1,249⁹⁹**
Part No. 6-397-WS1712



Automatic Cycle Bandsaws

MODEL BS-15A

Model BS-12A (12" Round Cap.)
Part No. 6-275-007
\$13,995⁰⁰

Model BS-15A (15" Round Cap.)
Part No. 6-275-009
\$16,975⁰⁰

FEATURES:

- Full auto cycle.
- 3 HP drive motor.
- 1" bi-metal blade.
- Cast iron construction.
- Net Weight: 1,800 or 2,200 lbs.
- Shipping Weight: 2,000 or 2,500 lbs.

AS LOW AS \$321.89/mo.



9" x 16" Horizontal Bandsaw

1-1/2 HP, 115/230V, 1 PH Motor

Model BAH-916
Part No. 6-271-025

\$3,695⁰⁰

AS LOW AS \$84.99/mo.

FEATURES:

- 9" round, 3" x 16" or 9" x 13" rectangular capacity @ 90°.
- 4 blade speeds with 1" x 129" blade.
- Hydraulic feed control.
- Built in coolant system.



FREE

High Speed Blade Included



Horizontal/Vertical Bandsaw

3/4 HP, 115V, 1 PH

FEATURES:

- 7" round, 7" x 12" rectangular capacity.
- Portable - Take to the job and plug it in.
- Hydraulic feed control.
- Built-in coolant system.
- 4 blade speeds.
- 3/4" x 93" blade.

Model HVBS-712
Part No. 6-200-033

\$2,816³¹



10" Variable Speed Horizontal Miter Bandsaw

2 HP, 230/460V, 3 PH Motor

Model BAH-1018M-VS
Part No. 6-280-015

\$7,290⁰⁰

AS LOW AS \$167.67/mo.

FEATURES:

- Hydraulic feed control.
- Built in coolant system.
- Variable blade speeds.
- 1" x 136.8" blade.
- Miter design with swivel saw bow.
- 10" round, 10" x 16" or 6" x 18" rectangular capacity at 90°.



Horizontal/Vertical Bandsaw

3/4 HP, 115V, 1 PH

FEATURES:

- Built in coolant system.
- Hydraulic feed control.
- 4 blade speeds.
- Portable - Take to the job and plug it in.

Model BAH-712
Part No. 6-280-005

\$1,699⁰⁰

SPECIFICATIONS:

Capacity....7" ● / 7" x 11" ■
Blade Size93" x 3/4"



nova™ 7" x 12" Nova Eclipse DVR Metal Cutting Bandsaw

1 HP, 120V, 1 PH Motor

FEATURES:

- Smart metal bandsaw combines common bandsaw features with state of the art technology.
- Powerful direct drive 1 HP high torque brushless motor without pulleys or belts to cause vibration.
- Digital Variable Reluctance (DVR) Direct Drive Technology with Adaptive Control™ Software.
- Includes a 240V conversion components kit which increases the HP of the motor.
- TRU-LOCK quick locking clamping vise system.

Model 59001
Part No. 6-125-080 **\$2,999⁰⁰**

SPECIFICATIONS:

Cutting Capacity:
90° Rectangular/Round 7" x 12"/7"
45° Rectangular/Round 4-1/2" x 5"/5"
Speeds 80-340 FPM
Blade 93" x 3/4" x 0.032"
Motor 15 AMP, 120V, 1PH, 60 Hz

NEW!

COMPLETE WITH:

- Blade.
- Workstop.
- Firmware.
- USB cable.
- Adjustment Wrenches.
- Vertical Saw Table.





Draw Bar Variable Speed

The Aussie ADB-123 power collet release max. is only 3 seconds!

FEATURES:

- Specially designed and patented universal mounting flange that adapts to all Taiwanese, Republic Laguna, Kondia, and Bridgeport Mills.
- 10 minute installation on all variable speed mills, CNC machines, and step pulley deads!
- Unique adjustable draw bar feature enables the operator to preset length of draw bar. No special one required!
- Requires only 80 PSI of compressed air to operate.

INCLUDES:

- Regulator and gauge.
- Air filter.
- Oil lubrication.
- "L" bracket with control gauge system mounted.
- Complete ADB-123 Power Draw Bar assembly.
- Mounting screws.
- Special allen wrench.
- Fitting.
- Oil.
- Operation and parts manual.
- PLUS step pulley adapter plate.



Model ADB-123
Part No. 1-541-ADB123 \$625⁵⁰
 Reg. Net Price \$695.00
2 YEAR WARRANTY MADE IN AUSTRALIA

GENERAL

Non-Contact Laser Tachometer

NEW!

save 20%

Ideal for high-speed motors, engines, gearboxes, fans, compressors.



FEATURES:

- Auto ranging.
- Laser precision.
- Wide measuring range.
- Range: 2.5-99,999 RPM
- Jumbo 5 digit LCD display.
- Memory: Min./Max./Last

INCLUDES:

- User's Manual
- (3) AAA Batteries
- 1 Year Limited Warranty
- Adhesive Reflective Tape

Supplied with a hard case.

Model LT2234C
Part No. 8-304-090
 Reg. Net Price \$112.68
\$90¹⁴



PALMGREN Arbor Presses



Delivers the heavy force needed for riveting, squeezing, punching, bending, and other pressing applications.

Sturdy, cast-iron construction. Removable, machined steel, 4-position anvil. Rugged steel ram is driven by a machined pinion. Base drilled for mounting on a bench or pedestal.

Force (Tons)	Swing	Max. Work Height	Ram Dimns. (SQ.)	Height	Weight (lbs.)	Part No. 1-549-	Reg. Net Price	SALE!
1.0	8"	6"	1"	11"	34	-AP10	\$208.00	\$176.80
2.0	10-3/8"	7-7/8"	1-1/4"	15-1/8"	70	-AP20	399.00	339.15
3.0	11-3/4"	12-1/2"	1-1/2"	21"	135	-AP30	619.00	526.15

AP10: Equipped with handwheel to perform light and quick press work.

Legacy FLEXZILLA

Zillanator™ Pro Gloves

NEW!

save 25%

High Dexterity

Flexzilla® Gloves ensure extreme flexibility, rugged durability and unrivaled comfort.

FEATURES:

- Adjustable Thermoplastic Rubber (TPR) wrist closure and pull tab.
- Touchscreen technology: Thumb, index and middle fingers.
- Reinforced fingertips, thumb saddle and padded knuckle.
- Ideal for: Multipurpose, Mechanic, Contractor.
- Machine washable.
- Padded synthetic leather palm.



Model GH361P - LARGE
Part No. 1-700-135 \$14⁷⁹
 Reg. Net Price \$19.72

Oil-Only White Pads

AMI-100 17" x 19" Double Weight

FEATURES:

- Does not absorb water.
- The economical choice to soak up hydraulic oil, diesel fuel or any petroleum-based fluid.
- Sonic bonds provide added strength unlike the competitions unbonded product.

Pack of 100

Part No. 1-835-714 \$70¹³
 Reg. Net Price \$82.51



JAPACHE Anti-Fatigue Matting

DIAMOND FOOT™ Black

Durable vinyl surface bonded to a resilient, Ergo Flex™ closed-cell foam, provides anti-fatigue & wear characteristics.

FEATURES:

- Beveled edges for safety.
- 9/16" thick ultra-comfort foam.
- Industry favorite diamond plate surface for enhanced traction.
- Diamond plate surface made from 100% recycled materials.
- Surface resists common fluids, most chemicals, and is non-flammable.



24" x 36" (9 lbs.)
Part No. 1-913-442S2436
 Reg. Net Price \$57.81
\$49¹⁴

Limited 3 year warranty against wear & delamination.

36" x 60" (22 lbs.)
Part No. 1-913-442S3660
 Reg. Net Price \$144.54
\$122⁸⁶

SHOP IRON Anti-Scratch Anti-Fog Welding Goggles

NEW!

FEATURES:

- Designed for gas welding & plasma cutting.
- Equipped with IR5 lenses that are designed to prevent scratching and fog build up.
- Frame Material: PVC (Polyvinyl chloride).
- Flexible 180° viewing angle.
- Can be used with glasses.
- Vented to eliminate fog.
- Meets ANSI Z87.1 standards.
- Lens Dimensions: 8-7/8" x 3-5/16".



Part No. 1-701-41217 \$17⁸⁸
 Reg. Net Price \$21.04

PFERD Chip Brushes

High volume/cost-effective brushes for wide range including painting, gluing, touch-up, chip removal, parts cleaning, and other industrial applications. Economy quality white bristle.



Box Qty. Pricing			
Brush Width	Box Qty.	Part No. 1-613-	ONLY!
1/2"	36	-740B	\$24.95
1	36	-741B	29.48
1-1/2	36	-742B	37.58
2	24	-743B	29.52
3	12	-745B	51.36

144 Pc. Chip Brush Assortment

INCLUDES:
(36) 1/2"
(36) 1" (24) 2"
(36) 1-1/2" (12) 3"

Part No. 1-613-746
\$139⁸⁵



Variable Speed Power Feed Bridgeport Hand Fed Mill

FEATURES:

- Gives you reliable, workhorse performance across a wide range of general purpose machining.
- Semi-automated machining on Class 1 mills to 3 HP.
- Helical gearing and torque limiting friction safety clutch with new and improved gear.
- Peak torque (half-wave series motor).

SPECIFICATIONS:

Intermittent Torque 105 in./lb.
Continuous Torque 90 in./lb.
Variable Feed Rate75-25 IPM
Rapid Traverse 35 IPM
Gear Reduction Ratio 72:1
Electrical 110V, 50/60 Hz, 2.5 Amps
Weight 15 lbs.

- INCLUDES:
- Limit switches.
 - Manual circuit breaker.
 - 6' ground line cord.
 - Complete instructions.
 - Mounting hardware.

Model #200-140
Part No. 2-011-079
Reg. Net Price \$881.28



\$793¹⁵

ERB Blue Denim Shop Apron

Our affordable line of quality aprons are made from ultra-durable fabrics.

FEATURES:

- Heavy-duty 10.5 oz. denim.
- Dark indigo color masks dirt and stains.
- Featuring nylon ties, pencil and patch pockets.
- 4" H divided chest pocket.
- Rugged and made to last.
- 5.25" H divided waist pocket.
- Size: 36" L x 24" W

Model No. F4
Part No. 1-720-18004 **\$9⁴⁹**
Reg. Net Price \$11.17



EDGE TECHNOLOGY Tailstock Alignment Bar

Used to align the tailstock to the headstock faster, easier, and accurate.

Part No. 1-811-27000
Reg. Net Price \$69.99
\$62⁹⁹

FEATURES:

- Durable anodized finish.
- Hardened steel bar ends are precision ground after assembly for superior accuracy.
- Bar end diameters are equal within 0.0001" and made from high strength aluminum.



Legacy 7 Pc. Flexzilla® High Flow Couplers & Plug Set

Flexzilla® High Flow couplers and plugs double the amount of air flow to your tool. Connect the fittings from your tool all the way to the compressor. This ensures the best performance your air system can provide. Don't starve your air tool!

Nickel Plated Steel with Anodized Aluminum Sleeve

SET INCLUDES:

- (1) FNPT Coupler.
- (1) MNPT Coupler.
- (2) FNPT Plugs.
- (3) MNPT Plugs.

FEATURES:

- Push connect system.
- Maximum torque and RPM.
- Ideal for spray guns, impact tools or any high output tool.
- Increased efficiency.

NEW!

LIMITED QUANTITIES



Part No. 1-914L-A53457FZ **\$22⁴⁹**
Reg. Net Price \$29.99

SPECIFICATIONS:

Connection Size 1/4" NPT
Body Size 1/4"
Maximum Pressure 300PSI
Color ZillaGreen

save 25%

PALMGREN 18" V-Roller Material Support Stand

The 18" V-Roller consists of two chrome-plated 2" x 5" ball bearing roller heads designed to smoothly move up to 2,000 lbs. round stock 1" - 18" diameter.

FEATURES:

- Made of heavy duty cast iron and steel for handling heavy loads of stock.
- A clamping mechanism on the column allows for quick and easy height adjustments.
- Locking screws provide added safety.

Part No. 1-549-MSV18 **\$169²⁰**
Reg. Net Price \$188.00

SPECIFICATIONS:

Length of Rollers 5"
Height 23" to 38-1/2"
Base 15" x 16-1/2"
Weight 47 lbs.



BluBird 3/8" x 25' Retractable Air Hose Reel

With 3' Lead-In Hose

REEL FEATURES:

- Solid brass fittings.
- L-Shaped base with groove reinforcement ensuring a stable support.
- 20 gauge powder coated steel construction.
- Horizontal and vertical wall mount options with adjustable guide arm. Can be mounted on wall, ceiling, and floor.
- Heavy-duty spring vibration resistant mechanism.
- Adjustable hose stopper and 4 non-sag rollers reduces hose abrasion. Complete with rubber gasket.
- Smooth auto-rewind with locking 12 point ratchet gearing system.

HOSE FEATURES:

- Solid brass fittings.
- 300 PSI working pressure with a 4:1 safety factor.
- Constructed with high strength polyester braided reinforcement.
- Ultra light, super strong rubber that resists abrasion and kinks.
- 40% Lighter than standard rubber hoses.
- Maintains integrity under extreme weather conditions. Flexible from -50°F to +122°F.
- 4 finger grip bend restrictor for better use and easier control over the hose.

Model BBR3825
Part No. 1-838-100K

\$125⁰³



NEW!

FREE KBC Blow Gun

INCLUDES:
• (1) 1-397-600S:
KBC Blow Gun.



COILHOSE PNEUMATICS 770 Pistol Grip Blow Gun

FEATURES:

- Variable flow control and is lightweight.
- Conforms to OSHA standards for noise levels and less than 30 PSI dead-ended pressure.
- Supplied with a brass reinforced inlet, 1/4" FPT.

Part No. 1-816-014 **\$12⁹⁵**
Reg. Net Price \$15.23



TEKTON Recoil Air Hose

25' x 1/4" Hose

FEATURES:

- Spring-type bend restrictors relieve the strain near hose ends.
- Made of lightweight nylon and premium brass connectors swivel 360°.
- After each use, the hose naturally springs back into its compact, coiled shape.

Part No. 1-397-610
Reg. Net Price \$16.70

\$15⁰³



Machinist Clamping Sets



SET INCLUDES:

- (6) T-slot Nuts
- (6) Flange Nuts
- (4) Coupling Nuts
- (6) Step Blocks
- (6) Serrated End Clamps
- (24) Studs, 4 each: 3", 4", 5", 6", 7", 8" lg.

Supplied with a plastic case.

Table T-Slot Size: 5/8"
Stud Size: 1/2"-13

Part No. 1-904-20402 **\$7132**
Reg. Net Price \$83.90

Table T-Slot Size: 1/2"
Stud Size: 3/8"-16

Part No. 1-904-20413 **\$7132**
Reg. Net Price \$83.90

TOOLMAKERS Construction Tooling Balls

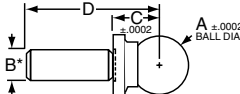

Precision ground shoulder provides precise "C" dimension to facilitate locating ball centerline. Heat treated steel.

*- Slip fit shank tolerance is plus .0000", minus .0004".
- Press fit shank tolerance is plus .0003", minus .0000".
- Ball and shank are concentric within .0002" T.I.R.



A	B*	C	D	Part No. 1-901-		Reg. Net Price	NOW!
				Slip Fit	Press Fit		
.2500"	.1250"	.200"	9/16"	-26805	-26806	\$23.83	\$20.26
.3750"	.1875"	.300"	3/4	-26810	-26811	24.85	21.12
.5000"	.2500"	.400"	15/16	-26815	-26816	25.88	22.00
.5000"	.2500"	.500"	1-3/8	-26820	-26821	28.21	23.98
.7500"	.3750"	.500"	1-1/4	-26830	-26831	35.72	30.36



Horizontal Hold-Down Clamps

STAINLESS STEEL



Supplied with spindle assembly.

Model	Overall Height	Height Under Bar	OAL	Holding Capacity (lbs.)	Part No. 1-910-	Reg. Net Price	SALE!
205-S*	3/4"	13/32"	2-3/4"	60	-52060	\$13.35	\$12.02
205-U*	3/4"	13/32"	2-3/4"	60	-52050	13.16	11.84
205-UR*	3/4"	13/32"	2-3/4"	60	-52055	17.02	15.32
213-U	1 1/16	3/4"	3-15/16	150	-52130	17.25	15.53
215-U	1-1/2	1	5-7/16	200	-52150	17.79	16.01
217-U	1-29/32	31/32	6-17/64	200	-52170	22.91	20.62
225-U	1-7/8	1-3/8	6-19/32	500	-52250	20.30	18.27
227-U	2-13/32	1-21/64	7-15/64	500	-52270	25.26	22.73
235-U	2-1/2	1-3/4	10-1/8	750	-52350	35.66	32.09
237-U	3-3/16	1-3/4	10-7/16	750	-52370	45.83	41.25

*S Solid Holding Bar (Bolt retainers furnished) -U "U" Shaped Holding Bar
*Plastic Spindle Assembly.

Steel Spring Clamps



Made with vinyl tips to prevent marring and vinyl handles for a non-slip grip. Features a heavy-duty spring for a tight fit and nickel plating to prevent corrosion.

Clamping Capacity	Throat Depth	Part No. 1-820B-	Reg. Net Price	SALE!
1"	1-1/4"	-XM3	\$2.21	\$1.99
2"	2-1/4"	-XM5	3.73	3.36
3"	3-5/16"	-XM7	6.93	6.24

TEKZ 70 Pc. Grease Fitting Assortment



SET INCLUDES:

- Straight
 - (10) 1/8"-27
 - (20) 1/4"-28
 - (10) 6mm x 1.0
 - (5) 8mm x 1.0
 - (5) 10mm x 1.0
- 45°
 - (5) 1/8"-27
 - (20) 1/4"-28
- 90°
 - (5) 1/8"-27
 - (5) 1/4"-28

Part No. 1-928-45215 **\$1432**
Reg. Net Price \$16.85

Supplied with a convenient re-sealable plastic case.

TEKZ 225 Pc. SAE O-Ring Assortment



SET INCLUDES:

- (10) 3/32" x 15/64"
- (20) 1/8" x 1/4"
- (20) 5/32" x 9/32"
- (20) 3/16" x 5/16"
- (15) 7/32" x 11/32"
- (15) 1/4" x 3/8"
- (15) 5/16" x 7/16"
- (10) 3/8" x 1/2"
- (10) 7/16" x 5/8"
- (10) 1/2" x 11/16"
- (10) 9/16" x 3/4"
- (10) 5/8" x 3/4"
- (10) 5/8" x 13/16"
- (10) 11/16" x 7/8"
- (10) 3/4" x 15/16"
- (10) 3/4" x 1"
- (10) 13/16" x 1-1/16"

Part No. 1-928-45225 **\$850**
Reg. Net Price \$10.00

Knurled Knobs



Thread Size	Head Dia.	Part No. 1-397-	Reg. Net Price	SALE!
10-24	3/4"	-300	\$2.70	\$2.30
1/4-20	1	-301	2.70	2.30
3/8-16	1-1/4	-302	3.89	3.31
1/2-13	1-1/2	-303	3.89	3.31
5/8-11	2	-304	7.31	6.21
3/4-10	2-1/2	-305	13.96	11.87

FEATURES:

- Suitable for many adjustment, clamping, or locating devices.
- Black shiny finish.
- Knurled head provides non-slip finger grip.



TITAN 10" Hand Riveter With Rivets



FEATURES:

- For use with 3/32", 1/8", 5/32", and 3/16" rivets.
- Suitable for steel, aluminum and plastic rivets.
- 4 interchangeable nosepieces.
- Anti-slip cushion grip handle.
- Includes 60 rivets.

Part No. 1-909-15052 **\$1704**
Reg. Net Price \$20.05

Machine Shop Trade Secrets

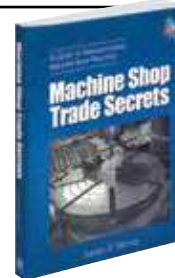

A Guide to Manufacturing Machine Shop Practices

FEATURES:

- Improve surface finishes and hold tighter tolerances.
- Remove broken taps, drill bits, and other hardware.
- Apply proven CNC techniques to maximize output.
- Improve surface finishes and old tighter tolerances.
- Assist engineers with design and manufacturing issues.

You will discover ways to:

- Surface grind blocks, pins and shapes.
- Work faster.
- Cut thread, knurl parts and eliminate warp.
- Choose realistic feeds, speeds and depths of cut.
- Select, make, and grind cutters.

Part No. 1-961-375 **\$5946**
Reg. Net Price \$69.95

Dryseal Socket Pressure Plugs

- FEATURES:**
- Thermo-forged.
 - Heat treated alloy steel.
 - NPTF 3/4" diametral taper per foot.



Pressure Plug Size	Length of Plug Nominal	Threads Per Inch	Part No. 1-908-	ONLY!
1/16"	5/16"	27	-474	\$.47
1/8"	5/16"	27	-475	.48
1/4"	7/16"	18	-476	.69
3/8"	1/2"	18	-477	1.07
1/2"	9/16"	14	-478	2.03
3/4"	5/8"	14	-479	3.90
1	3/4"	11-1/2	-480	12.27
1-1/4	13/16"	11-1/2	-481	29.22

T-Slot Cleaner

Very useful item for every machinist to clean the T-slots on your machine table.



1" Wide
7/16" T-Slot Size

Part No. 1-909-400 **\$130**



Little GIANT Utility Pump

FEATURES:

- Corrosion- and rust-resistant, epoxy-coated cast aluminum pump.
- FKM triple-lip seal.
- Upper and lower ball bearings for long life.
- 1" FNPT (25.4 mm) discharge (includes garden hose adapter for quick plug and play).
- Manual operation, pumps down to 1/8" with screen, and down to 1/16" without screen.
- 120°F (49°C) maximum liquid temperature rating.

NEW!



Model 5-MSP

Part No. 1-440-505723 **\$176¹⁶**
Reg. Net Price \$207.25

Gallons Per Minute					Shut Off	PSI
1'	3'	5'	10'	20'		
1500	1464	1395	1191	528	26'	11.43

[Click here for complete details.](#)



8" Sidewinder™ Tube Skimmer

The Sideways Skimmer™ Skims from Anywhere.

FEATURES:

- Skims hard to access or enclosed sumps.
- Skims across elongated surface areas.
- Continuous duty, fan cooled motor.
- Weighted tube keeps from walking.
- Ceramic scraper wipes tube clean.
- Compact and versatile design.
- Installs in seconds.
- Rated at 1 quart per hour.
- Skims underneath conveyors.
- Skims oil spills.
- Ceramic scraper lasts forever.



Part No. 1-122-016
Reg. Net Price \$404.56
\$343⁸⁸



Workforce® Series Pistol Grip Grease Gun

The highest standards for engineering and craftsmanship are built into every Workforce® Grease Gun making them the choice for those who work under rugged conditions.

FEATURES:

- Heavy-duty die cast head construction for maximum durability and longer service life.
- 4-Jaw coupler for better and longer service life.
- Non-slip knurled barrel for better grip.
- 12" flexible extension for hard to reach grease fittings.
- Durable follower rod and spring for consistent priming.
- Positive grip follower handle.
- Includes filler nipple port.

Part No. 1-914L-L1325
Reg. Net Price \$28.99
\$24⁶⁴



Multi-Purpose Bearing Grease

Developed to outperform conventional bearing grease and extend re-lubrication periods. Ideal for lubricating all type of bearings and will prolong bearing life. It will reduce maintenance costs and grease consumption. Excellent load carrying properties.

Part No. 1-444-70614 **\$13⁹⁵**
Reg. Net Price \$16.31



TRI-COOL™ TC-1 Premium Synthetic Coolant

5 Gallon

ECOLOGICALLY SAFE

TC-1 is a highly concentrated premium synthetic water soluble coolant formulated to exceed the demands of spray and flood cooling. It contains a non-chlorine extreme pressure additive for improved tool and surface finish. TC-1 prevents rusting on tool and surface finish. It contains a broad spectrum biocide/fungicide for protection against growth. TC-1 is non-toxic, non-flammable, and biodegradable.

Part No. 1-439-30657 **\$254⁶⁶**
Reg. Net Price \$282.95



DYKEM Layout Fluid

FEATURES:

- Allows scribing of sharp, clear, precise lines reducing eyestrain.
- Provides a thin coat that dries in minutes without cracking or chipping, revealing defects and pinholes in a variety of surfaces.

TOULENE-FREE



Size	Part No. 1-442-	Reg. Net Price	NOW!
8 oz. Brush Cap Can	-001	\$15.68	\$14.11
12 oz. Aerosol	-002	17.64	15.88

Adjustable Coolant Hose System Kits

THE ORIGINAL MODULAR HOSE SYSTEM!

FEATURES:

- Electrically non-conductive and ideal for use as an EDM flushing hose.
- Will stay in position without any springback. Creep due to machine vibration is eliminated.
- Fully hand-adjustable in both position and length.



KITS INCLUDE:

- Male NPT Connectors: 3/8", 1/2"
- Nozzles: 1/16", 1/8", 1/4"
- 13" Length with Fittings: (2) 5-3/4" Segments

1/4" Hose Kit
Part No. 1-836-40413 **\$8⁸⁷**
Reg. Net Price \$9.85

1/2" Hose Kit
Part No. 1-836-50813 **\$9⁹⁸**
Reg. Net Price \$11.09

EXAIR® Cold Gun Aircoolant System™

Replace messy mist systems. Improve dry machining with clean, cold air!



The Cold Gun produces a stream of clean, cold air at 50°F (28°C) below supply air temperature. Operation is quiet and there are no moving parts to wear out. It will remove heat to prolong tool life and increase productivity on machining operations when liquid coolants cannot be used.

Gun is non-adjustable to prevent freeze-up during use. Cold airflow and temperature drop are factory set to optimize the gun's cooling capability.



Model 5230

Includes: High Power Cold Gun, Single Point Hose Kit, 3/8" Cone Nozzle, 1-1/4" Fan Nozzle, Automatic Drain Filter Separator

Part No. 1-541-5230 **\$442⁴⁰**
Reg. Net Price \$553.00



Model 5330

Includes: High Power Cold Gun, Dual Point Hose Kit, (2) 1/4" Cone Nozzles, (2) 1" Fan Nozzles, Automatic Drain Filter Separator

Part No. 1-541-5330 **\$452⁸⁰**
Reg. Net Price \$566.00



DL MAGNUM Spray Cooling System

For Milling, Drilling, Turning, Boring, & Grinding.

FEATURES:

- Independent liquid and air controls.
- 60 lb. mounting magnet stays in place while offering maximum flexibility.
- Check valve minimizes delay of fluid delivery upon start-up.
- Pick-up filter prevents clogging.
- Heavy-duty metal nozzle conduit offers maximum durability; nozzle stays in position.
- Increased chip clearing power and reduced overspray.



SPECIFICATIONS:
Supply Pressure 60-120 PSI
Inlet Fitting 1/4" NPT or 1/4" BSPT

Part No. 1-439-30633 **\$201³⁷**
Reg. Net Price \$223.74

13 Pc. Combination Pin Punch Set

FEATURES:

- Tool steel, hardened and tempered; centerless ground.
- Uniformly heat treated, knurled body for easy gripping.

8 Pcs. (1/16 to 5/16") - Length: 4"
5 Pcs. (1/8 to 3/8") - Length: 8"

Part No. **1-397-SPC85** **\$20²¹**
Reg. Net Price \$26.95

save **25%**



MAYES

Pocket Size Combination Square With Scriber and Level

6" pocket combination square. Blade graduated in 8ths and 16ths on one side, 16ths and 32nds on the other side.

Part No. **1-930-10227** **\$10⁹⁷**
Reg. Net Price \$12.90



CRESCENT **WISS** 10" Heavy-Duty Titanium Coated Tradesman Shears

FEATURES:

- Heavy-duty blades feature premium grade stainless steel and are precision engineered for knife-like cutting edges.
- Serrated bottom blade grips material as it is being cut for increased cutting control and cleaner cuts.
- Titanium coated blades provide corrosion resistance and are 3X harder than steel for durability and tool life.
- Control channel accommodates index finger for increased control and cutting stability.
- Full metal core extends through the handle for maximum strength and increased durability.
- Touch point ergonomics optimize hand and finger contact points in handles to maximize fit, control, and user ergonomics.

Part No. **1-552-CW10TM**
Reg. Net Price \$27.09
\$23⁰³



CRESCENT 2 Pc. Grip Zone™ V-Jaw Dual Tongue & Groove Plier Set

FEATURES:

- V-shaped jaws allow for a firmer grip on various shapes.
- Rivet construction with precision machined joint interlock assures smooth, positive joint action, no chance of slipping position or coming apart under load.
- Angled teeth for increased gripping on pipes and fasteners.
- Unique tooth design grips tighter, giving you increased torque using less effort.
- Black oxide finish wipes clean easily and resists corrosion.
- Maximum durability from alloy steel construction with induction-hardened teeth.
- Integrated non-marring Grip Zone™ pipe grip area in the handle, made of high-impact rubber.

Includes: 10" & 12" Pliers
Part No. **1-552-RT400** **\$45²¹**
Reg. Net Price \$53.19



KNIPLEX Diagonal Cutters

FEATURES:

- High cutting performance with minimum effort due to optimum co-ordination of the cutting edge angle and transmission ratio.
- For very tough, continuous use.
- Precision cutting edges (cutting edge hardness approx. 64 HRC) cuts several types of wire including piano wire.
- Chrome vanadium heavy-duty steel; forged, oil-hardened.



8" Overall Length
Part No. **1-926-7401200** **\$40¹⁰**
Reg. Net Price \$47.18

10" Overall Length
Part No. **1-926-7401250** **\$52⁵⁶**
Reg. Net Price \$61.83

Milwaukee **FASTBACK™** Folding Utility Knives

NEW!

Compact Folding

FEATURES:

- Press and flip opening.
- Quick change.
- Durable wire belt clip.
- Blade holder designed for scoring.
- Metal extension to prevent accidental blade removal.
- Compact size.



Part No. **1-828-48221500** **\$8⁹⁷**

Folding with Blade Storage

FEATURES:

- Press and flip opening.
- Quick Change: Tool free blade change.
- Durable wire belt clip.
- Blade holder designed for scoring.
- Metal extension to prevent accidental blade removal.
- Metal body.



Part No. **1-828-48221502** **\$14⁹⁷**

- Wire stripper.
- Gut hook.
- Stores 5 extra blades.
- Fits most utility blades.

Milwaukee **3/8" Ratchet & Socket Sets** With **PACKOUT™** Low-Profile Compact Organizer

NEW!

FEATURES:

- **FOUR FLAT™** Sides feature wrench-ready design and socket deter rolling.
- 90-Tooth design with 4° of arc swing for tight work spaces.
- Sockets with stamped sizes.
- Slim profile ratchet.
- Impact resistant body.
- IP65 rated protection.
- 3" & 6" Extensions.
- Universal hose adapter.
- Heavy-duty latches and reinforced hinge.
- Clear top for easy identification of contents.
- 90-Tooth ratchet with flush directional lever.
- Removable inner tray specifically designed for steel storage.



1-828-48229481 SHOWN

32 Pc. Metric Set
Deep Well Sockets: 6 to 19mm
Standard Sockets: 6 to 19mm
Part No. **1-828-48229482**

28 Pc. Inch Set
Deep Well Sockets: 1/2 to 9/16"
Standard Sockets: 1/2 to 1"
Part No. **1-828-48229481**

\$124⁹⁷

\$124⁹⁷

Milwaukee **106 Pc. Metric & SAE Ratchet & Socket Set** With **PACKOUT™** Low-Profile Compact Organizer

NEW!

FEATURES:

- **FOUR FLAT™** Sides feature wrench-ready design and socket deter rolling.
- Clear top for easy identification of contents.
- 90-Tooth design with 4° of arc swing for tight work spaces.
- Removable inner tray specifically designed for steel storage.
- Sockets with stamped sizes.
- Slim profile ratchet.
- Impact resistant body.
- IP65 rated protection.
- Heavy-duty latches and reinforced hinge.



SET INCLUDES:

- 1/4" Drive 50 Pc. Ratchet & Socket Set - SAE & Metric. Size Range: 5/32 to 9/16", 5 to 15mm.
- 3/8" Drive 56 Pc. Ratchet & Socket Set - SAE & Metric. Size Range: 1/4" to 1", 6 to 19mm.

Part No. **1-828-48229486**
\$314⁹⁹

5 Pc. Screw Extractor Set



For removing broken screws, bolts, studs, and pipes.

Sizes Included: #1 to #5.
Supplied in a plastic pouch.

Part No. **1-397-6716** **\$7⁰¹**
Reg. Net Price \$8.25



EVOLUTION® 15" Metal Cutting Chop Saw
With Cast Aluminum Base

- FEATURES:**
- Heavy-duty cast aluminum base with wear plate and bench mounting holes.
 - Quick-release vise with robust square-threaded rod.
 - Ergonomic, ambidextrous trigger.
 - Attachable "v" shape block included for secure clamping of round and square tube.
 - 10 ft. rubber power cord included.

- INCLUDES:**
- 14" Mild Steel Blade with 66 Teeth (14BLADEST).
 - Hex key: 5/16" (8mm).
 - V-Block Adaptor.
 - Instruction Manual.

- PLUS!** **\$42.00 Value!**
- INCLUDES:**
- (6) 1-613-742: KBC 1-1/2" Chip Brush.
 - (1) 1-711-BK110: BEARKAT Clear Lens Safety Glasses.
 - (1) 1-909-830: KBC Carbide Scriber.
 - (1) 1-909-007: KBC Baseball Cap.
 - (1) 1-816G-LZR600: GUARD AIR Lazer Blow Gun.



Model S380CPS
Part No. 1-827-410K
\$479⁰⁰



FREE KBC TOOLING KIT



Cut-Off Tool
With 3" Cut Off Wheel
Rear Exhaust



- FEATURES:**
- Modern high polished aluminum housing design.
 - Precision collet for secure bit retention.
 - Safety lock-off lever prevents accidental start-ups.

SPECIFICATIONS:

Air Consumption 4 CFM
Air Pressure 90 PSI
Air Inlet 1/4" NPT
No Load Speed ... 20,000 RPM
Total Length 7"

Model FPX-200
Part No. 1-829-901
Reg. Net Price \$44.00
\$37⁴⁰

Shop ALL Evolution Power Tools with Free KBC Kits!

AIRCAT® 1/4" Composite Straight Die Grinder
Rear Exhaust

- FEATURES:**
- Patented quiet tuned exhaust (82 dBA).
 - Feather trigger for better speed control.
 - Superior steel grade internal bearings for longer life.

SPECIFICATIONS:

Air Consumption 4.2 CFM
Air Inlet 1/4" NPT
Horsepower 0.5 HP
No Load Speed 22,000 RPM
Tool Length 8.5"



NEW! Model 6201
Part No. 1-830-035
\$102⁰⁰

PALMGREN POWERGRIND-XP™ 6" Variable Speed Bench Grinder
With Dust Collection

- FEATURES:**
- Variable speed inverter delivers a broad range of continuous speeds to fit any application.
 - Powerful, heavy-duty capacitor motors provide additional torque and plenty of power at all speeds without any loss of RPM's at full load.
 - LED speed readout with "soft" touch on/off and variable speed control pad.
 - Three hard speed switch settings 900 / 1,800 / 3,600 RPM. Variably adjust the speed up or down in 100 RPM increments.
 - Dynamically balanced rotors and sealed bearings.
 - Extended wheel to wheel clearance.
 - Exclusive single port dust collection.



NEW! Part No. 1-549-82096
Reg. Net Price \$718.00
\$646²⁰

SPECIFICATIONS:

Motor 1/2 HP, 115/240V, 1 PH
No Load Speed (3) .. 900 / 1,800 / 3,600 RPM
Arbor Size 1/2"



M12 FUEL™ 1/4" Right Angle Die Grinder

- FEATURES:**
- 4-MODE speed control.
 - Includes a wrench.
 - Greater mobility and access. No air hoses, compressors, or daily maintenance.
 - Compact tool size allows access in tight spaces.
 - Optimum performance with 2" accessories.
 - POWERSTATE™ brushless motor technology.
 - Compatible with all M12™ batteries.

SPECIFICATIONS:

Collet Size 1/4"
Voltage 12V
Horsepower 0.3 HP
No Load Speed 0-24,500 RPM
Dimensions 7.8" x 2.2" x 4.4"

NEW! Part No. 1-828-2485-20
\$199⁰⁰



1/2" Impact Wrench
With Rocker Switch and Friction Ring Socket Retention

- FEATURES:**
- AC/DC rocker switch enables quick selection of forward and reverse.
 - Friction ring socket retention system reduces downtime on applications involving frequent changing of accessories.
 - Complete with 8" fixed rubber cord that has durable construction for longer tool life.

SPECIFICATIONS:

Drive Size 1/2"
Amperage 7 AMPS
Max. Torque 300 ft./lbs.
No Load Speed 1,800 RPM
Impact Rate 2,600 IPM
Length 11-5/8"

NEW! Part No. 1-828-9071-20
\$199⁰⁰



M18™ FUEL 2-Tool Combo Kit

- HAMMER DRILL FEATURES:**
- Only 6.9" in length for access into tight spaces and reduced fatigue.
 - Fastest drilling and driving applications under load.
 - Auto-stop feature to protect from overrotation in a bindup for enhanced safety, equipped with a dedicated autostop light on foot of tool to indicate a protection event.
 - LED light for better visibility in low-light situations.
 - 1/2" all-metal chuck with carbide teeth for maximum durability, grip and bit retention.
 - Mechanical clutch for consistency in driving a wide range of fasteners.
 - Hammer drill mode for fast drilling into brick, block, or concrete.

HAMMER DRILL SPECIFICATIONS:

Chuck Capacity 1/2"
Blows Per Minute 0-33,000
Max. Torque 1,400 in./lbs.
No Load Speed 0-2,100 RPM
Dimensions 8.23" x 6.95" x 2.38"

Part No. 1-828-3697-22
\$399⁰⁰

- HEX IMPACT DRIVER FEATURES:**
- Increase productivity on the jobsite with the fastest driving speed of any impact driver without sacrificing power or control.
 - Ultimate trigger control by providing smooth acceleration for small fasteners to prevent stripping of screws or damaging of materials.
 - Tri-LED lighting for maximum workspace visibility.
 - Compact size (4.47") for access in tight spaces.
 - Self-tapping screw mode is designed to reduce walking when starting self-tapping screws as well as reduce overdriving, breaking, and stripping out screws.

HEX DRIVER SPECIFICATIONS:

Drive Size 1/4"
Max. Torque 2,000 in./lbs.
No Load Speed (4) 0-3,900 RPM
Impact Rate 0-4,400 IPM
Dimensions 5.4" x 3.9" x 9.5"

- KIT INCLUDES:**
- (1) M18 FUEL™ 1/2" Hammer Drill/Driver.
 - (1) M18 FUEL™ 1/4" Hex Impact Driver.
 - (1) M18™ & M12™ Multi-Voltage Charger.
 - (2) M18™ REDLITHIUM™ XC5.0 Extended Capacity Battery Pack.
 - (1) Side Handle. • (2) Belt Clip. • (1) Blow Molded Case.



SHOP WHENEVER, WHEREVER FROM
THE CONVENIENCE OF YOUR DEVICE



Download the
**KBC Tools
Mobile App
TODAY!**



3M Scotch® Super 33+™ Vinyl Electrical Tape

FEATURES:

- Premium grade, 7 mil. thick, all-weather vinyl-insulating tape.
- Temperature Range: 0°F - 220°F
- Excellent resistance to abrasion, moisture, alkalies, acids, corrosion and varying weather conditions (including ultraviolet exposure).
- Dielectric Strength: 1,150 mV



OVERSTOCK SALE!
Quantities Limited.

3/4" x 52 ft. Roll
Part No. **1-720-706133**
Reg. Net Price **\$8.53**

\$5.97



24/7 All Tools...
All The Time.

**24/7 PICK-UP
LOCKERS**



Check out the big red lockers outside our KBC Michigan location. Just order during regular business hours and pick up your order anytime!

Your tools... your time.

4 LOCATIONS TO SERVE YOU!

Showroom Hours: Monday to Friday 8am - 5pm



Detroit

6300 18 Mile Rd.
Sterling Heights, MI 48314
Local Calls (586) 979-0500
Fax Main Line .. (586) 979-4292
Hours: Monday to Friday 7am - 5pm



Machinery Division

6465 18 Mile Road
Sterling Heights, MI 48314
Local Calls (586) 731-3600
Fax Main Line .. (586) 731-7464

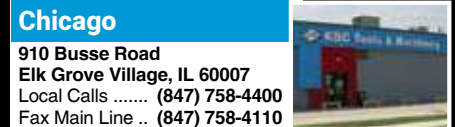

Chicago

910 Busse Road
Elk Grove Village, IL 60007
Local Calls (847) 758-4400
Fax Main Line .. (847) 758-4110



Los Angeles

1021 S. Placentia Ave.
Fullerton, CA 92831
Local Calls (714) 278-0500
Fax Main Line .. (714) 278-0505

PHONE HOURS: Mon-Fri. 8am - 8pm, EST

6 Pc. Telescoping Gage Set

"DOUBLE ACTION"
Self-Centering



FEATURES:

- Rigid handle with self-centering feature.
- Satin chrome finish.
- Sizes: 5/16- 6".
- Made of hardened tool steel.

Part No. **8-412-004C** **\$19.20**
Reg. Net Price **\$24.00**

Supplied in a plastic case.



360° Electronic Digital Angle Protractors

FEATURES:

- Stainless steel rule blades with inch and metric marking scales.
- Scale readings: 1/16", 1/32", 1/64" & MM.
- Strong metal locking nut.
- Large LCD digital displays in degrees.
- Reversible reading.
- Hold function.
- Inside and outside angle measurements.
- Auto shut-off.
- CR2032 Battery included.



NEW!



SPECIFICATIONS:

Measuring Range 0-360°
Resolution 0.05°
Accuracy ±0.3°
Repeatability 0.1°

Blade Size
Front: 8" Rear: 10"
Part No. **1-815-205**
Reg. Net Price **\$29.43**

\$25.02

Blade Size
Front: 4" Rear: 7"
Part No. **1-815-203**
Reg. Net Price **\$24.86**

\$21.13

LUTZ 8" File Card

Used for
general cleaning
of file teeth.



Part No.
1-611-005
Reg. Net
Price **\$10.50**
\$9.45

Cyclone Manufacturing Sandblast Metal Cabinets with Dust Collection

FEATURES:

- Top quality AMERICAN MADE.
- Manufactured to perform well for years.
- Top or side opening for easy access - even for heavy and bulky items.
- Can be used with most blasting abrasives for cleaning, deburring and finishing metal products, dies and tooling.
- Seams are welded and sealed to keep dust inside cabinet.
- Automatic air shut-off prevents blasting while tops are open.
- Canister dust collector reduces dust collection mess.
- Air Requirements: 14 CFM.
- Cabinet front is slanted to reduce back fatigue.

SPECIFICATIONS:

Working Dimensions	4224	4826
Height	24"	26"
Width	42"	48"
Depth	24"	26"
Overall Dimension		
Height	60"	58"
Width	45"	48-1/2"
Depth	46"	26-1/2"



Model 4224



Model 4826

Model 4224
Part No. **2-011-4224**
Reg. Net
Price **\$1,715.00**
\$1,543.50

Model 4826
Part No. **2-011-4826**
Reg. Net
Price **\$1,905.00**
\$1,714.50

FREE 50 Lb. Medium
Glass Bead Media
60-100 Grit VALUE **\$59.63**
Use Promo Code: **FREE0424M**

TEKZ 4 Pc. Pry Bar Set

FEATURES:

- Lengths Included: 8", 12", 18", & 24".
- Tough polypropylene handle grips.
- Forged carbon steel with black oxide finish.

Part No.
1-909-17103
Reg. Net
Price **\$21.96**
\$18.67



NEW!

WEB:
KBCTools.com

PHONE:
1-800-521-1740

FAX:
1-800-322-4292

